

FLORIDA DEPARTMENT OF NATURAL RESOURCES  
CERTIFIED CORNER RECORD

JAN 18 1994

SURVEY & MAPPING

CORNER DESCRIPTION:

S.E. corner of Section 11  
Twp 42 S, Rge 21 E  
Tallahassee Base Meridian,  
CHARLOTTE County(s), Florida.

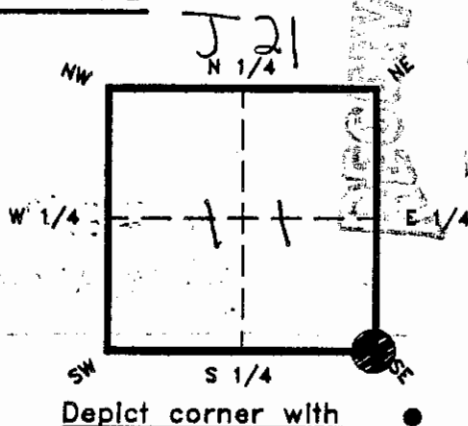

MONUMENTATION DESCRIPTION:

Describe original monument and accessories, or subsequent restoration. Give sources of information. (If no attempt was made to search for the original monument and accessories, this information is not necessary.)

Fnd 4" X 4" Conc Mon.

RECEIVED

JAN 10 1994

Description of corner evidence found:

State method(s) to determine corner location (lost corners only): SURVEY & MAPPING

HORIZONTAL POSITION INFORMATION ( If determined ):

Latitude 26° 47' 43.170 Longitude 82° 10' 28.705  
276 431.794 782 640.551  
Y(Northing) 206928.458 X(Easting) 579214.405 Zone 0902  
Convergence (-)00° 04' 43.75" Scale factor 0.99994490

Coordinate determination (circle one): Field traverse   GPS

Horizontal datum (circle one): NAD27 NAD83(1986)  NAD83(1990) other (explain)

Order of accuracy as defined in "Standards and Specifications for Geodetic Control Networks" published by the Federal Geodetic Control Committee (circle one):  
1st,  2nd, 3rd, class 1

or Minimum Technical Standards (Chapter 21HH-6, F.A.C.) ratio of closure for field data (example 1:10,000), \_\_\_\_\_ . This does not specify an order of accuracy.

Control point(s) used for survey:

Comments:

G.P.S. Coord. Furnished by Charlotte Co. Survey Dept.

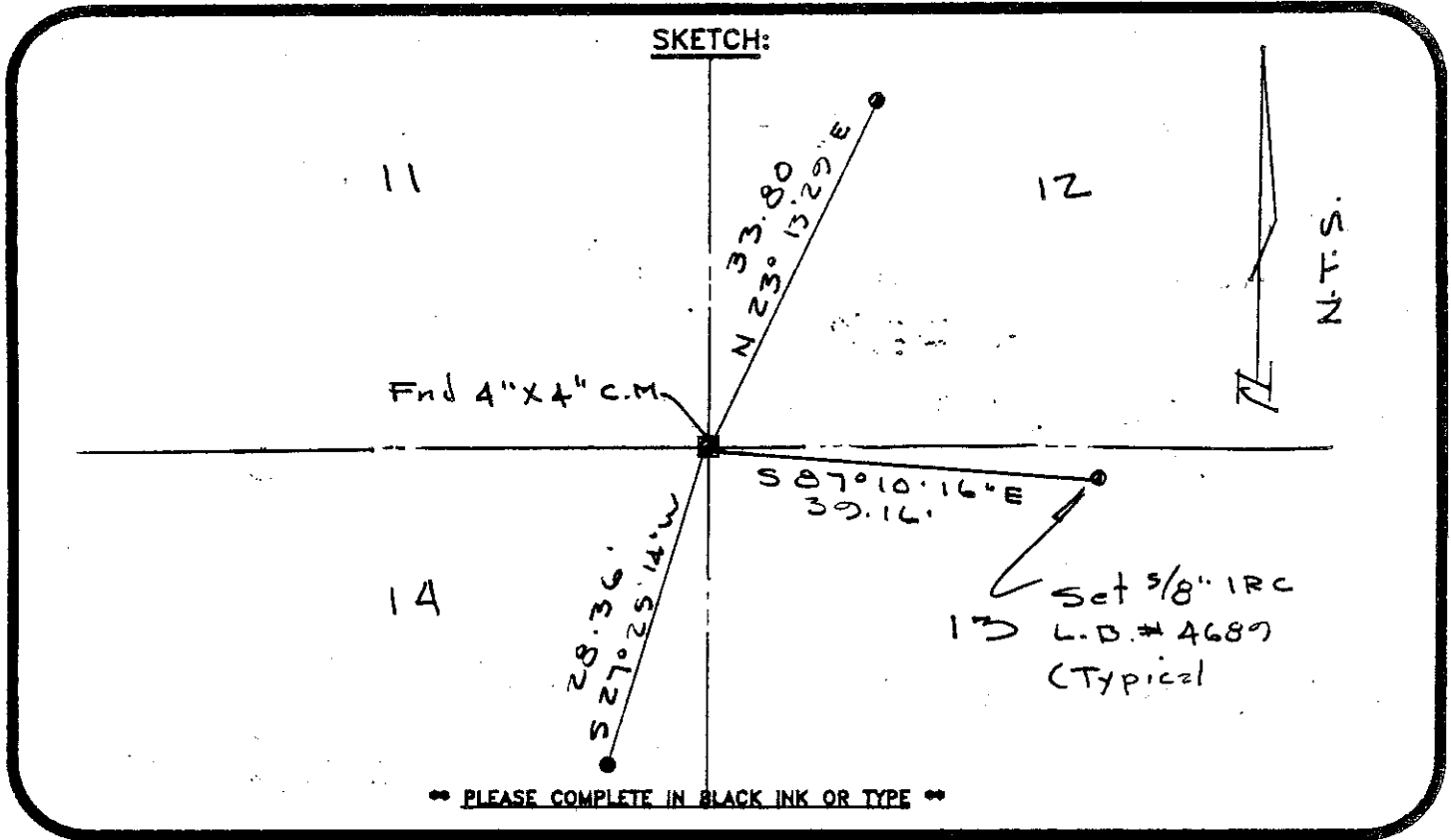

All bearings and distances must be from the corner to the witness. Indicate whether corner was found, set, or replaced and show north arrow.

REFERENCE MEASUREMENTS ( at least three vicinity references must be given below even if they appear on the above sketch ):

Description	Bearing	Distance
Set 3/8" IRC L.B.#4689	N.23°13'29"E	33.80
"	S.87°10'16"E	39.16
"	S.27°25'14"W	28.36

**SURVEYORS CERTIFICATE:** I certify the monument and accessories indicated above were field located on June 10, 1993.

[Signature] 3361  
SIGNATURE PLS NO.  
1-4-94  
DATE  
 Landmark Land Consultants L.B. 4689  
FIRM OR AGENCY L.B. NO.  
 4526 N. Access Road  
ADDRESS  
 Englewood, Florida 34224  
CITY STATE

474

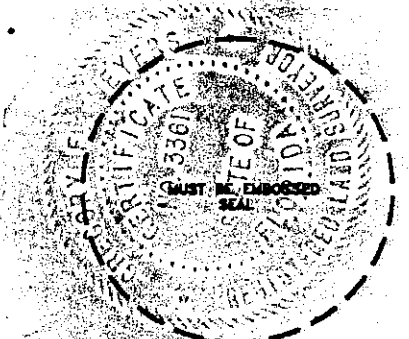

Completeness checked by: GJC  
 Accepted and filed: 2-1-94  
Date  
 B.L.M. - I.D. 1411213 D.N.R. USE ONLY

**SEND TO:**  
 Department of Natural Resources  
 Bureau of Survey and Mapping  
 3900 Commonwealth Boulevard  
 Mail Station 105  
 Tallahassee, Florida 32399  
 DNR 53-001(16)  
 REV. 7/16/92  
 PAGE 2 OF 2