

FLORIDA DEPARTMENT OF ENVIRONMENTAL PROTECTION
CERTIFIED CORNER RECORD

CORNER DESCRIPTION:

W. 1/4 corner of Section 4
Twp 42 S., Rge 23 E.
Tallahassee Base Meridian,
CHARLOTTE County(s), Florida.

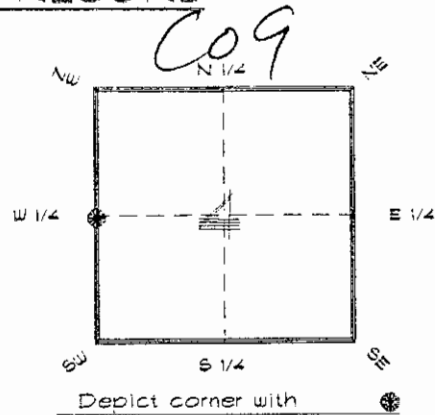

MONUMENTATION DESCRIPTION:

Describe original monument and accessories, or subsequent restoration. Give sources of information. (If no attempt was made to search for the original monument and accessories, this information is not necessary.)

Description of corner evidence found:

1/2" IRON ROD

State method(s) to determine corner location (lost corners only):

RECEIVED

JAN 31 1995

SURVEY & MAPPING

HORIZONTAL POSITION INFORMATION (if determined):

Latitude 26°51'04.20291" N Longitude 82°01'19.09657" W
Y(Northing) 278914.217 m X(Easting) 197816.509 m Zone FLW
Convergence -0°00'35.726" scale factor 0.99994124

Coordinate determination (circle one): Field traverse (GPS)

Horizontal datum (circle one): NAD27 NAD83(1986) NAD83(1990) other (explain)

Order of accuracy as defined in Standards and Specifications for Geodetic Control Networks published by the Federal Geodetic Control Committee (circle one):
1st, 2nd, 3rd, class 1

or Minimum Technical Standards (Chapter 61G17, F.A.C.) ratio of closure for field data (example 1:10,000), . This does not specify an order of accuracy.

Control point(s) used for survey: CHARLOTTE COUNTY HORIZONTAL CONTROL NETWORK INCLUDES HAVOLINE 2, FLACIDA 2, W260, PUNTPORT, 4 FLGPS 58 48 B ORDER STATIONS.

Comments:

4223C09

DOC. #

051020

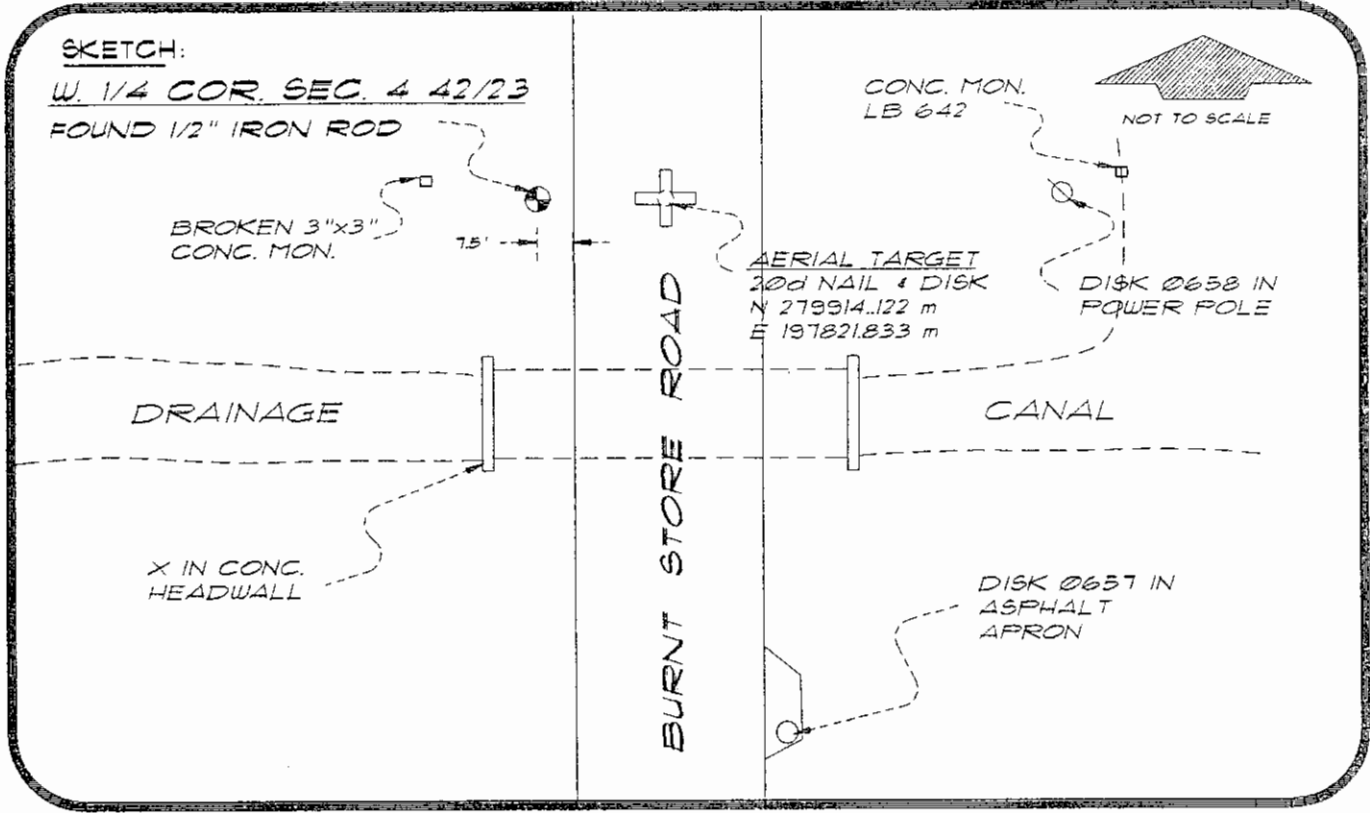

BASIS OF BEARING SOLAR OBSERVATION

REFER: FB 285/49

REFERENCE MEASUREMENTS

Description	Bearing	Distance
DISK 0658 IN P. POLE	N 89°28'35" E	62.29'
DISK 0657 IN ASPHALT	S 26°12'46" E	81.85'
X IN CONC. HEADWALL	S 05°56'21" W	33.11"
CONC. MON. LB 642	N 89°57'22" E	67.50'
BROKEN CONC. MON.	N 86°56'07" W	18.07'
AERIAL TARGET	S 88°59'15" E	17.47'

SURVEYOR'S CERTIFICATE: I certify the monument and accessories indicated above were field located on MARCH 9, 1994

R. P. Roszko
SIGNATURE

PLS 4260

UPDATED 1/26/95

1/30/95
DATE

CHARLOTTE COUNTY SURVEY DEPT.
FIRM OR AGENCY

7000 FLORIDA STREET
ADDRESS

PUNTA GORDA, FLORIDA 33950
CITY STATE

473



Completeness checked by: B. Lent
 Accepted and filed: 3-1-95 Date
 BLM. - ID. 0500104 DNR. USE ONLY

SEND TO:

Department of Environmental Protection
 Bureau of Survey and Mapping
 3300 Commonwealth Boulevard
 Mail Station 105
 Tallahassee, Florida 32393