

4223T05

DOC. #

051043

FLORIDA DEPARTMENT OF ENVIRONMENTAL PROTECTION CERTIFIED CORNER RECORD

CORNER DESCRIPTION:

W. 1/4 corner of Section 29,
 Twp 42 S., Rge 23 E.
 Tallahassee Base Meridian,
CHARLOTTE County(s), Florida.

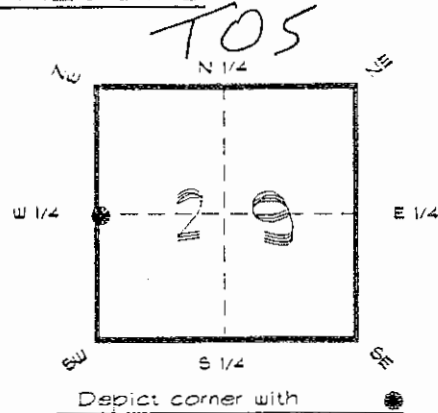

MONUMENTATION DESCRIPTION:

Describe original monument and accessories, or subsequent restoration. Give sources of information. (If no attempt was made to search for the original monument and accessories, this information is not necessary.)

Description of corner evidence found:

RAILROAD SPIKE

State method(s) to determine corner location (lost corners only):

RECEIVED

JAN 31 1995

SURVEY & MAPPING

HORIZONTAL POSITION INFORMATION (if determined):

Latitude 26°47'32.91953" N Longitude 82°02'17.01955" W
 Y(Northing) 272412.102 m X(Easting) 196215.574 m Zone FLW
 Convergence -0°01'01.763" Scale factor 0.99994135

Coordinate determination (circle one): Field traverse GPS

Horizontal datum (circle one): NAD27 NAD83(1986) NAD83(1990) other (explain)

Order of accuracy as defined in Standards and Specifications for Geodetic Control Networks published by the Federal Geodetic Control Committee (circle one):
 1st, 2nd, 3rd, class _____

or Minimum Technical Standards (Chapter 6IG17, F.A.C.) ratio of closure for field data (example 1:10,000), _____ . This does not specify an order of accuracy.

Control point(s) used for survey: CHARLOTTE COUNTY HORIZONTAL CONTROL NETWORK INCLUDES HAVOLINE 2, PLACIDA 2, W260, FUNTPORT, & FLGPS 38 45 B ORDER STATIONS.

Comments:

051043

4223T05

DOC. #

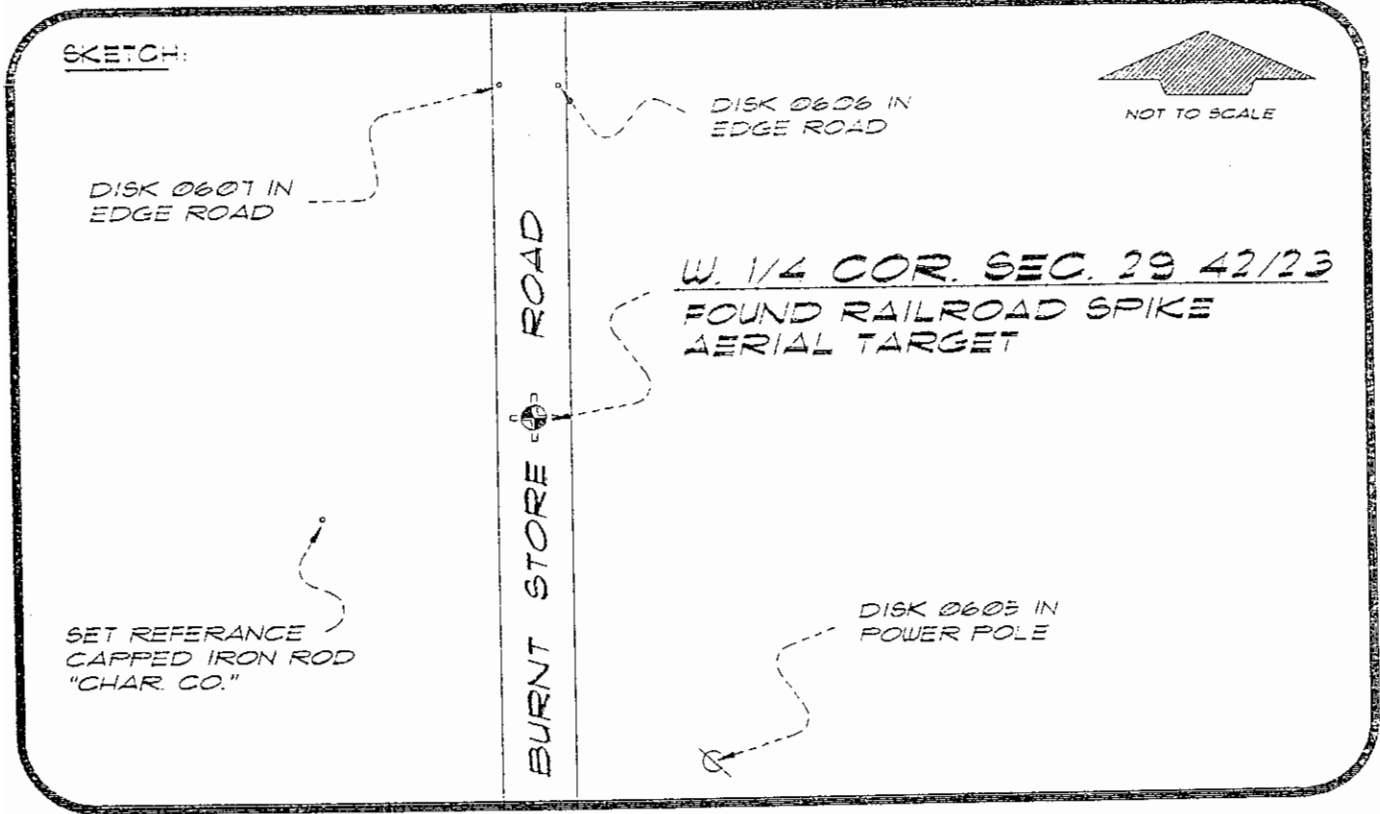

BASIS OF BEARING SOLAR OBSERVATION

REFER: FB 285/39

REFERENCE MEASUREMENTS

Description	Bearing	Distance
DISK 0607 IN EDGE ROAD	N 03°01'08" W	121.51'
DISK 0606 IN EDGE ROAD	N 05°23'34" E	120.79'
DISK 0605 IN P. POLE	S 19°42'53" E	136.97'
SET REF. IRON ROD	S 60°59'27" W	55.44'

SURVEYORS CERTIFICATE: I certify the monument and accessories indicated above were field located on FEBRUARY 17, 1994

R. P. Ross
SIGNATURE

PLS 4260

UPDATED 1/26/95

1/30/95
DATE

CHARLOTTE COUNTY SURVEY DEPT.
FIRM OR AGENCY

1000 FLORIDA STREET
ADDRESS

PUNTA GORDA, FLORIDA 33950
CITY STATE

Completeness checked by: *[Signature]*
 Accepted and filed: *[Signature]*
 BLM. ID. 3000629 Date 3-1-95
 DNR USE ONLY

473



SEND TO:

Department of Environmental Protection
Bureau of Survey and Mapping
3900 Commonwealth Boulevard
Mail Station 105
Tallahassee, Florida 32399