

FLORIDA DEPARTMENT OF ENVIRONMENTAL PROTECTION
CERTIFIED CORNER RECORD

V13

CORNER DESCRIPTION:

S. W. corner of Section 27
Twp 42 S. , Rge 23 E.
Tallahassee Base Meridian,
CHARLOTTE County(s), Florida.

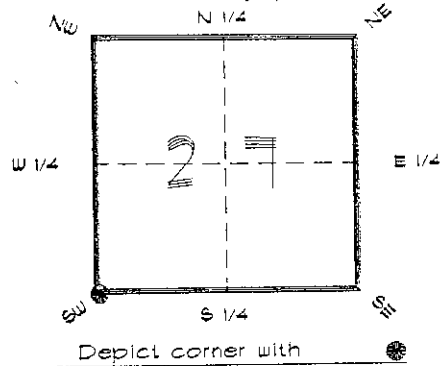

MONUMENTATION DESCRIPTION:

Describe original monument and accessories, or subsequent restoration. Give sources of information. (If no attempt was made to search for the original monument and accessories, this information is not necessary.)

Description of corner evidence found:

6" DIA. CONCRETE MONUMENT (DAMAGED), SET CONCRETE MONUMENT ABOVE.

State method(s) to determine corner location (lost corners only):

HORIZONTAL POSITION INFORMATION (if determined):

Latitude 26°47'06.33072" N Longitude 82°00'19.97064" W
Y(Northing) 271593.249 m X(Easting) 199448.383 m Zone FLW
Convergence -0°00'09.000" Scale factor 0.99994118

Coordinate determination (circle one): Field traverse (GPS)

Horizontal datum (circle one): NAD27 NAD83(1986) (NAD83(1990)) other (explain)

Order of accuracy as defined in Standards and Specifications for Geodetic Control Networks published by the Federal Geodetic Control Committee (circle one):
1st, 2nd, 3rd, class 1

or Minimum Technical Standards (Chapter 61G17, F.A.C.) ratio of closure for field data (example 1:10,000), . This does not specify an order of accuracy.

Control point(s) used for survey: CHARLOTTE COUNTY HORIZONTAL CONTROL NETWORK INCLUDES HAYOLINE 2, FLAGIDA 2, W260, PUNTPORT, & FLGPS 58 AS B ORDER STATIONS.

Comments:



FEB 20 1995

051040

4223V13

DOC. #

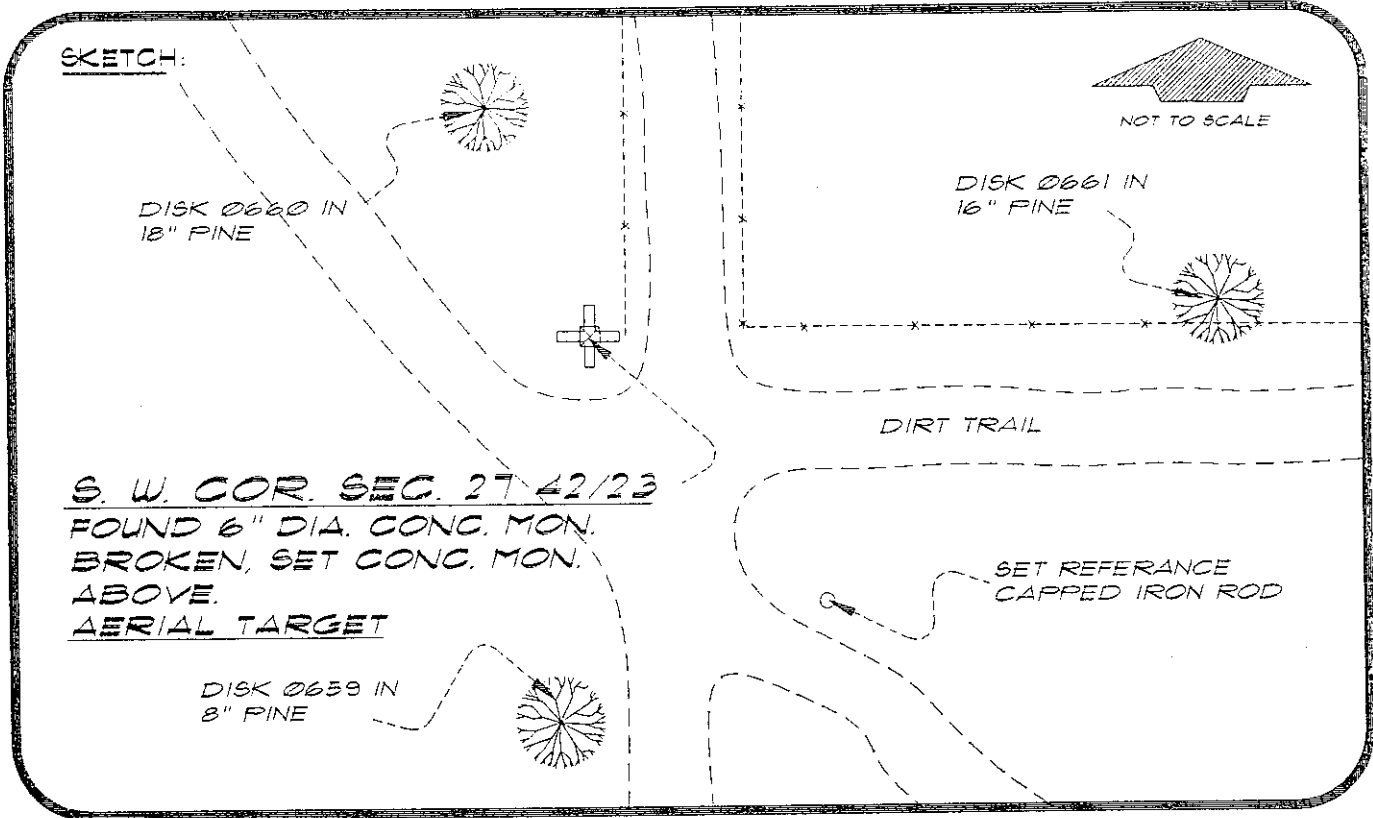

S. W. COR. SEC. 27 42/23
 FOUND 6" DIA. CONC. MON.
 BROKEN, SET CONC. MON.
 ABOVE.
AERIAL TARGET

BASIS OF BEARING SOLAR OBSERVATION REFER: FB 285/51
 SET SURVEY MARKER POST 3' N'LY

REFERENCE MEASUREMENTS

Description	Bearing	Distance
DISK 0660 IN 18" PINE	N 22°48'07" W	47.27'
DISK 0661 IN 16" PINE	N 87°05'57" E	78.89'
DISK 0659 IN 8" PINE	S 04°02'14" W	64.36'
SET REF IRON ROD	S 41°47'43" E	34.36'

SURVEYORS CERTIFICATE: I certify the monument and accessories indicated above were field located on MARCH 10, 1994

R. R. Rose
 SIGNATURE

PLS 4260

UPDATED 2/8/95

2-15-95
 DATE

CHARLOTTE COUNTY SURVEY DEPT.
 FIRM OR AGENCY

7000 FLORIDA STREET
 ADDRESS

PUNTA GORDA, FLORIDA 33950
 CITY STATE

473

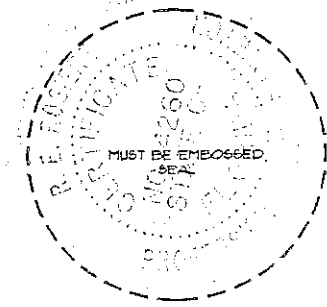

Completeness checked by *R. R. Rose*
 Accepted and filed: 3-1-95 Date
 B.L.M. - I.D. 33202734 D.E.P. USE ONLY

SEND TO:

Department of Environmental Protection
 Bureau of Survey and Mapping
 3900 Commonwealth Boulevard
 Mail Station 105
 Tallahassee, Florida 32399