

FLORIDA DEPARTMENT OF ENVIRONMENTAL PROTECTION
CERTIFIED CORNER RECORD

DOC. # 092734

CORNER DESCRIPTION: MONUMENTATION DESCRIPTION (EVIDENCE FOUND OR METHOD TO SET)

Depict corner with ●

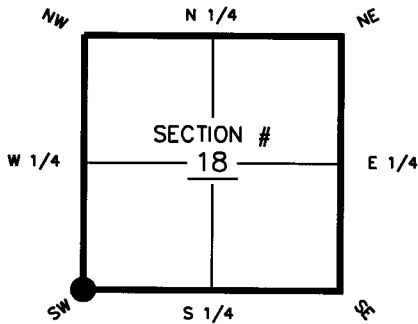

FOUND 4"X4" CONCRETE MONUMENT
(TOP BROKEN)

HORIZONTAL POSITION INFORMATION (if determined):

Latitude 26°-48'-51.28522" Longitude 81°-57'-22.99761"
 Y(NORTHING-Ft.) 901651.966 X(EASTING-Ft.) 670390.775 Zone WEST
 Convergence 0°-01'-10.8" Scale factor 0.99994141
 Coordinate determination (circle one): Field traverse (GPS)
 Horizontal datum (circle one): NAD27 NAD83(1986) (NAD83(1990)) other (explain)
 Accuracy (circle one): 1st 2nd (3rd) other _____

SW corner of Section 18
 Twp 42S, Rge 24E
 Tallahassee Base Meridian,
 CHARLOTTE County(s), Florida

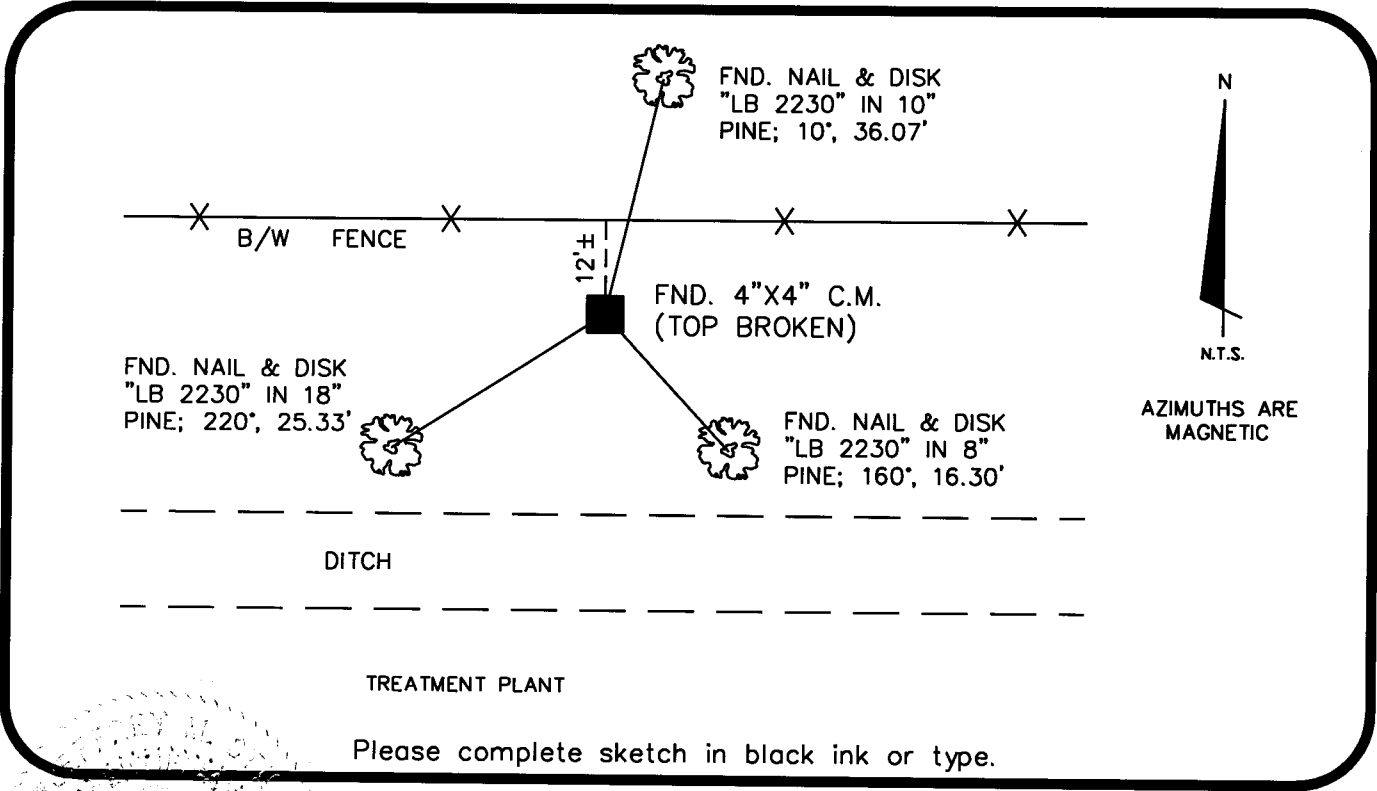

Please complete sketch in black ink or type.

SURVEYORS CERTIFICATE:

I certify the monument and accessories indicated above were field located on 6-11-07

[Signature] 6389
 SIGNATURE PSM NO.
MCKIM & CREED 6566
 FIRM OR AGENCY LB NO.
10970 SOUTH CLEVELAND AVE., SUITE 401
 ADDRESS
FORT MYERS FL 33907
 CITY STATE ZIP
(239) 275-8875 10-30-07
 PHONE NUMBER DATE

SEND ORIGINAL TO:
 Department of Environmental Protection
 Bureau of Surveying and Mapping
 3900 Commonwealth Boulevard
 Mail Station 105
 Tallahassee, Florida 32399

DE.P. USE ONLY
 Processed: 11-8-07 MB
 B.L.M. - I.D. 100400
 QUAD - I.D. 2316 Gilchrist

EMBOSSSED SEAL OVER SIGNATURE