

FLORIDA DEPARTMENT OF ENVIRONMENTAL PROTECTION  
CERTIFIED CORNER RECORD

DOC. # 092754

CORNER DESCRIPTION:      MONUMENTATION DESCRIPTION (EVIDENCE FOUND OR METHOD TO SET)

Depict corner with ●

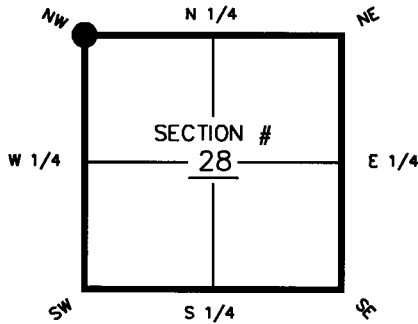

FOUND 4"X4" CONCRETE MONUMENT  
(NO I.D.)

HORIZONTAL POSITION INFORMATION (if determined):

Latitude 26°-47'-56.85194" Longitude 81°-55'-24.88755"  
 Y(NORTHING-Ft.) 896160.822 X(EASTING-Ft.) 681094.623 Zone WEST  
 Convergence 0°-02'-04.0" Scale factor 0.99994189  
 Coordinate determination (circle one):      Field traverse (GPS)  
 Horizontal datum (circle one): NAD27    NAD83(1986) (NAD83(1990)) other (explain) \_\_\_\_\_  
 Accuracy (circle one):      1st      2nd      (3rd)      other \_\_\_\_\_

NW corner of Section 28  
 Twp 42S, Rge 24E  
 Tallahassee Base Meridian,  
 CHARLOTTE County(s), Florida

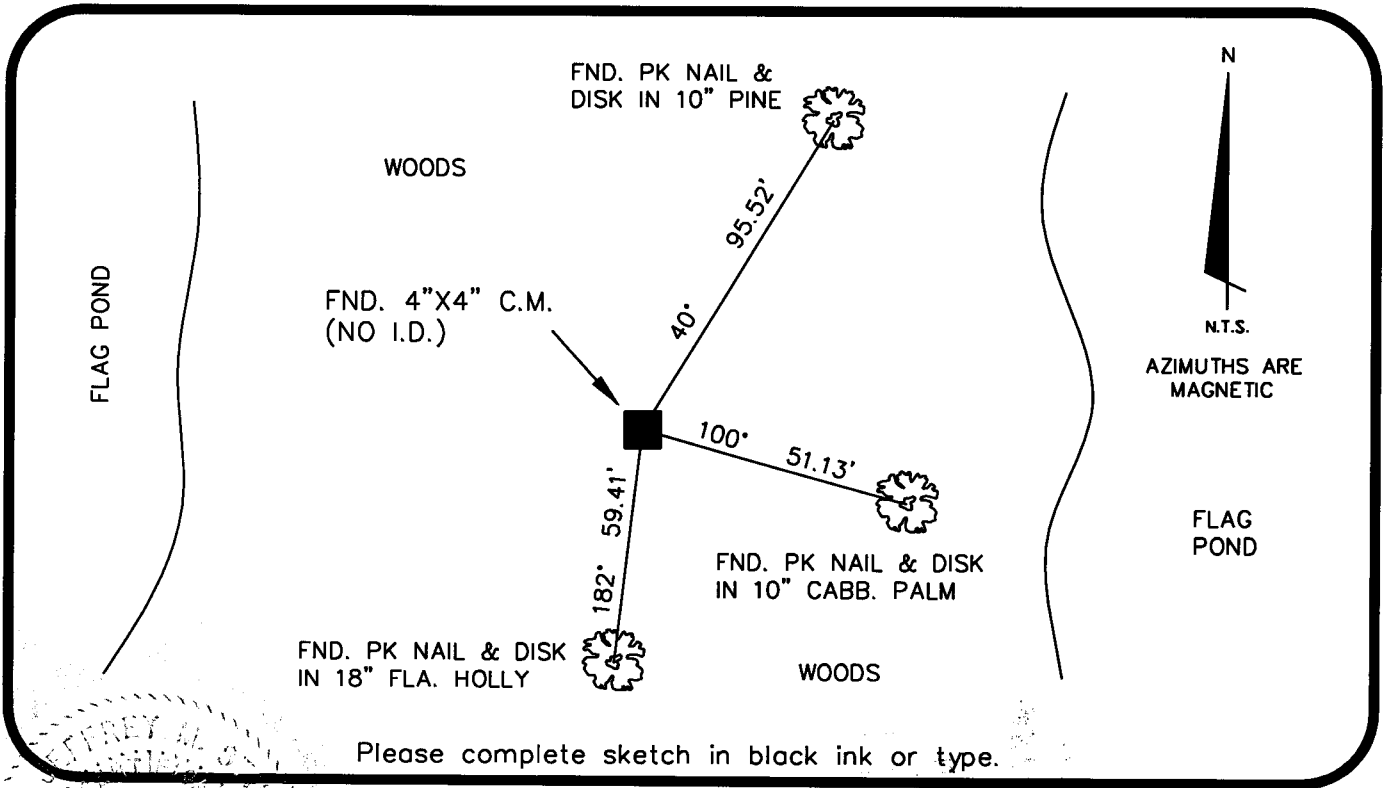

SURVEYORS CERTIFICATE:

I certify the monument and accessories indicated above were field located on 6-06-07

*Jeffrey M. Stee*      6389  
 SIGNATURE      PSM NO.  
McKIM & CREED      6566  
 FIRM OR AGENCY      LB NO.  
10970 SOUTH CLEVELAND AVE., SUITE 401  
 ADDRESS  
FORT MYERS      FL      33907  
 CITY      STATE      ZIP  
(239) 275-8875      10-30-07  
 PHONE NUMBER      DATE

SEND ORIGINAL TO:  
 Department of Environmental Protection  
 Bureau of Surveying and Mapping  
 3900 Commonwealth Boulevard  
 Mail Station 105  
 Tallahassee, Florida 32399

**D.E.P. USE ONLY**

Processed: 11-8-07 MB

B.L.M. - I.D. 300300

QUAD - I.D. 2316 Gilchrist

EMBOSSSED SEAL OVER SIGNATURE