

FLORIDA DEPARTMENT OF ENVIRONMENTAL PROTECTION

CERTIFIED CORNER RECORD

DOC. # 089372

CORNER DESCRIPTION: **MONUMENTATION DESCRIPTION (EVIDENCE FOUND OR METHOD TO SET)**

Depict corner with A-1

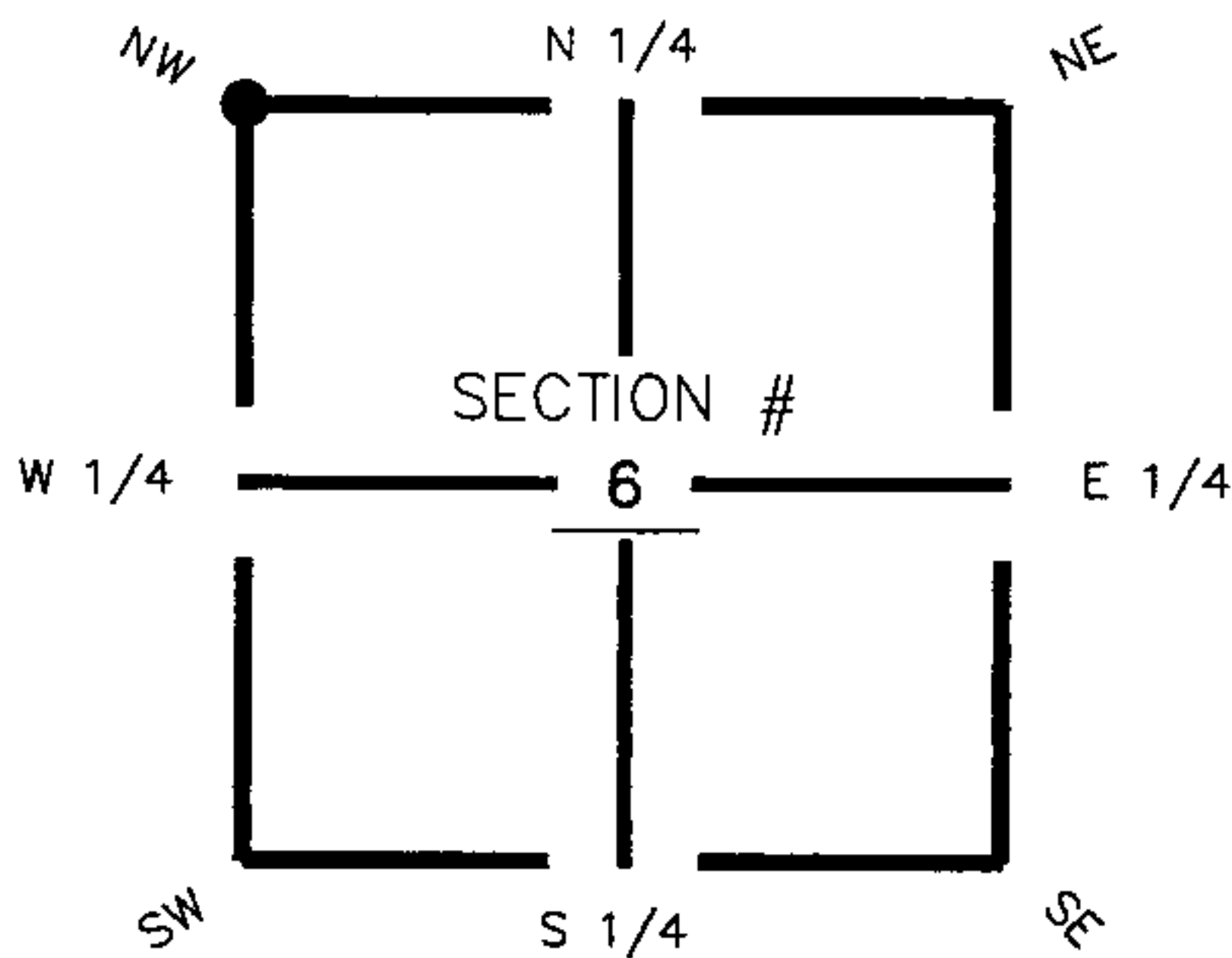

Set $\frac{3}{4}$ " Iron Pipe & Cap
(LB 642)

NW corner of Section 6
Twp 42 South, Rge 27 East
Tallahassee Base Meridian,
Charlotte County(s), Florida

HORIZONTAL POSITION INFORMATION (if determined):

Latitude 26° 51' 25.89057" N Longitude 81° 39' 44.61047" W
Y(NORTHING-Ft.) 917406.79 X(EASTING-Ft.) 766237.42 Zone FL83-WF
Convergence 0° 09' 09.07958" Scale factor 0.999955067
Coordinate determination (circle one): Field traverse (GPS)
Horizontal datum (circle one): NAD27 NAD83(1986) NAD83(1999) other (explain)
Accuracy (circle one): 1st (2nd) 3rd other _____

1. 353' 27.35'. Set PK Nail and Trav. Pt. Disc (LB 642) in E. face of fence post.

2. 317' 7.08'. Set PK Nail and Trav. Pt. Disc (LB 642) in E. face of fence post.

3. 217' 10.35'. Set PK Nail and Trav. Pt. Disc (LB 642) in E. face of fence post.

N.W. Sec.6, Twp.42S., Rge.27E.
Set $\frac{3}{4}$ " Iron Pipe & Cap
(LB 642).

Field Book: LB-33, Page 32

SURVEYORS CERTIFICATE:

I certify the monument and accessories indicated above were field located on November 4, 2005

[Signature] 4912
SIGNATURE PSM NO.
Johnson Engineering, Inc. 642
FIRM OR AGENCY LB NO.
251 West Hickpoghee (SR80) ADDRESS
La Belle Florida 33935
CITY STATE ZIP
(863) 612-0594 November 8, 2005
PHONE NUMBER DATE

SEND ORIGINAL TO:
Department of Environmental Protection
Bureau of Surveying and Mapping
3900 Commonwealth Boulevard
Mail Station 105
Tallahassee, Florida 32399

D.E.P. USE ONLY

Processed: 11-13-06 MB

B.L.M. - I.D. 100700

QUAD - I.D. 2314 Telegraph Swamp

EMBOSSSED SEAL OVER SIGNATURE