

# FLORIDA DEPARTMENT OF ENVIRONMENTAL PROTECTION CERTIFIED CORNER RECORD

DOC. # 089373

CORNER DESCRIPTION: MONUMENTATION DESCRIPTION (EVIDENCE FOUND OR METHOD TO SET)

Depict corner with  A-5

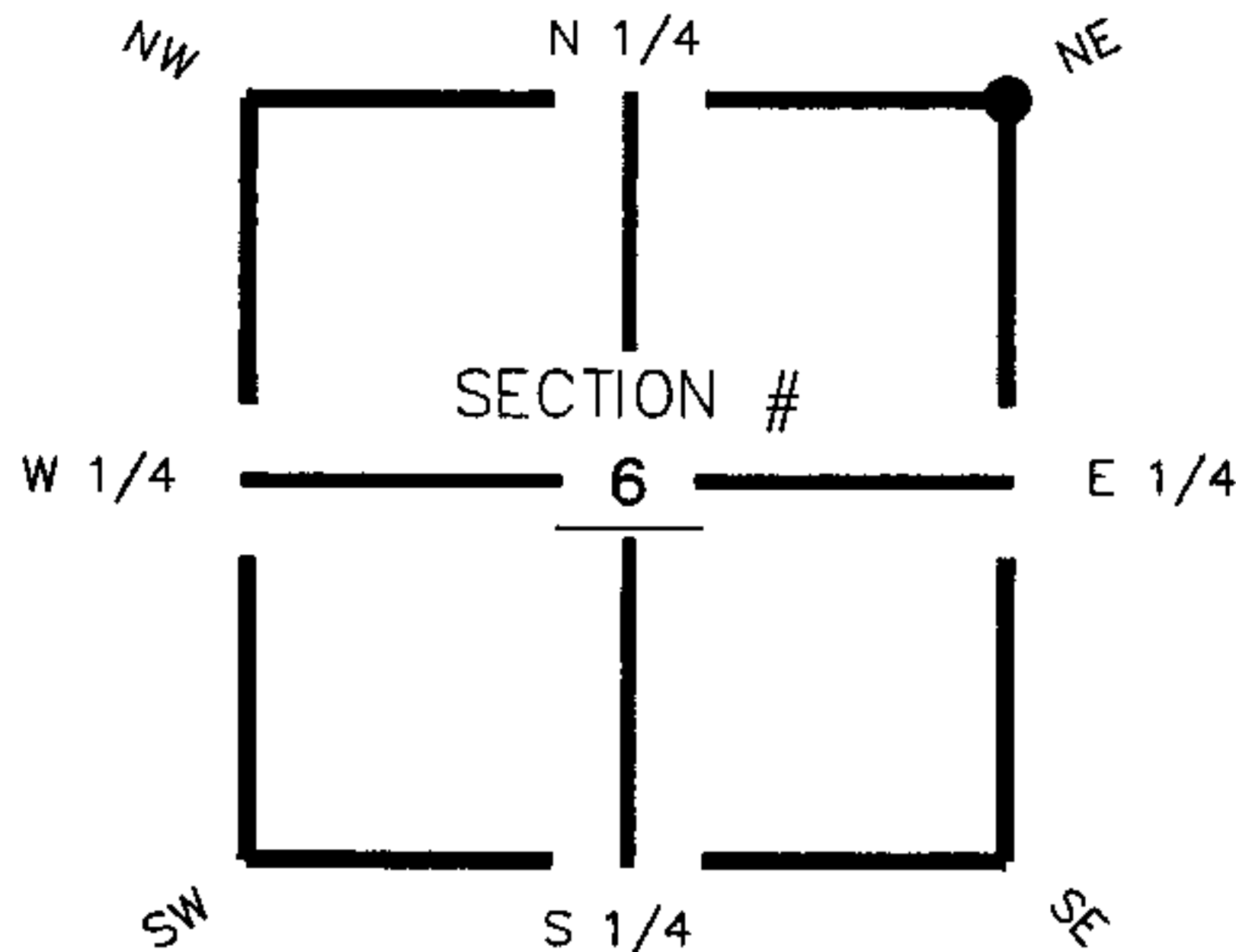

Set  $\frac{3}{4}$ " Iron Pipe & Cap  
(LB 642)

HORIZONTAL POSITION INFORMATION ( if determined ):

Latitude 26° 51' 26.72521" N Longitude 81° 44' 36.35122" W  
 Y(NORTHING-Ft.) 917429.17 X(EASTING-Ft.) 739815.87 Zone FL83-WF  
 Convergence 0° 06' 57.28081" Scale factor 0.999949199

NE corner of Section 6  
 Twp 42 South , Rge 27 East  
 Tallahassee Base Meridian,  
Charlotte County(s), Florida

Coordinate determination (circle one): Field traverse (GPS)  
 Horizontal datum (circle one): NAD27 NAD83(1986) (NAD83(1999)) other (explain)  
 Accuracy (circle one): 1st (2nd) 3rd other \_\_\_\_\_

1. 108° 29.48'. Set PK Nail and Trav. Pt. Disc (LB 642) in N. face of 4" Pine.
2. 179° 51.45'. Set PK Nail and Trav. Pt. Disc (LB 642) in W. face of 4" Pine.
3. 276° 24.20'. Set PK Nail and Trav. Pt. Disc (LB 642) in N. face of 4" Pine.

N.E. Cor Sec.6, Twp.42S., Rge.27E.  
Set  $\frac{3}{4}$ " Iron Pipe & Cap (LB 642).

Field Book: LB-33, Page 47

SURVEYORS CERTIFICATE:

I certify the monument and accessories indicated above were field located on November 11, 2005

*[Signature]*  
 SIGNATURE \_\_\_\_\_ 4912  
 Johnson Engineering, Inc. \_\_\_\_\_ PSM NO. 642  
 FIRM OR AGENCY \_\_\_\_\_ LB NO. \_\_\_\_\_  
 251 West Hickpochee, (9880) \_\_\_\_\_ ADDRESS \_\_\_\_\_  
 La Belle, Florida 33935 \_\_\_\_\_ CITY STATE ZIP  
 (863) 612-0594 \_\_\_\_\_ PHONE NUMBER DATE August 10, 2006

SEND ORIGINAL TO:  
 Department of Environmental Protection  
 Bureau of Surveying and Mapping  
 3900 Commonwealth Boulevard  
 Mail Station 105  
 Tallahassee, Florida 32399

D.E.P. USE ONLY

Processed: 11-13-06 MB

B.L.M. - I.D. 197700

QUAD - I.D. 2314 Telegraph Swamp

EMBOSSSED SEAL OVER SIGNATURE