

# FLORIDA DEPARTMENT OF ENVIRONMENTAL PROTECTION CERTIFIED CORNER RECORD

DOC. # 089370

**CORNER DESCRIPTION:**      **MONUMENTATION DESCRIPTION (EVIDENCE FOUND OR METHOD TO SET)**

Depict corner with  A-13

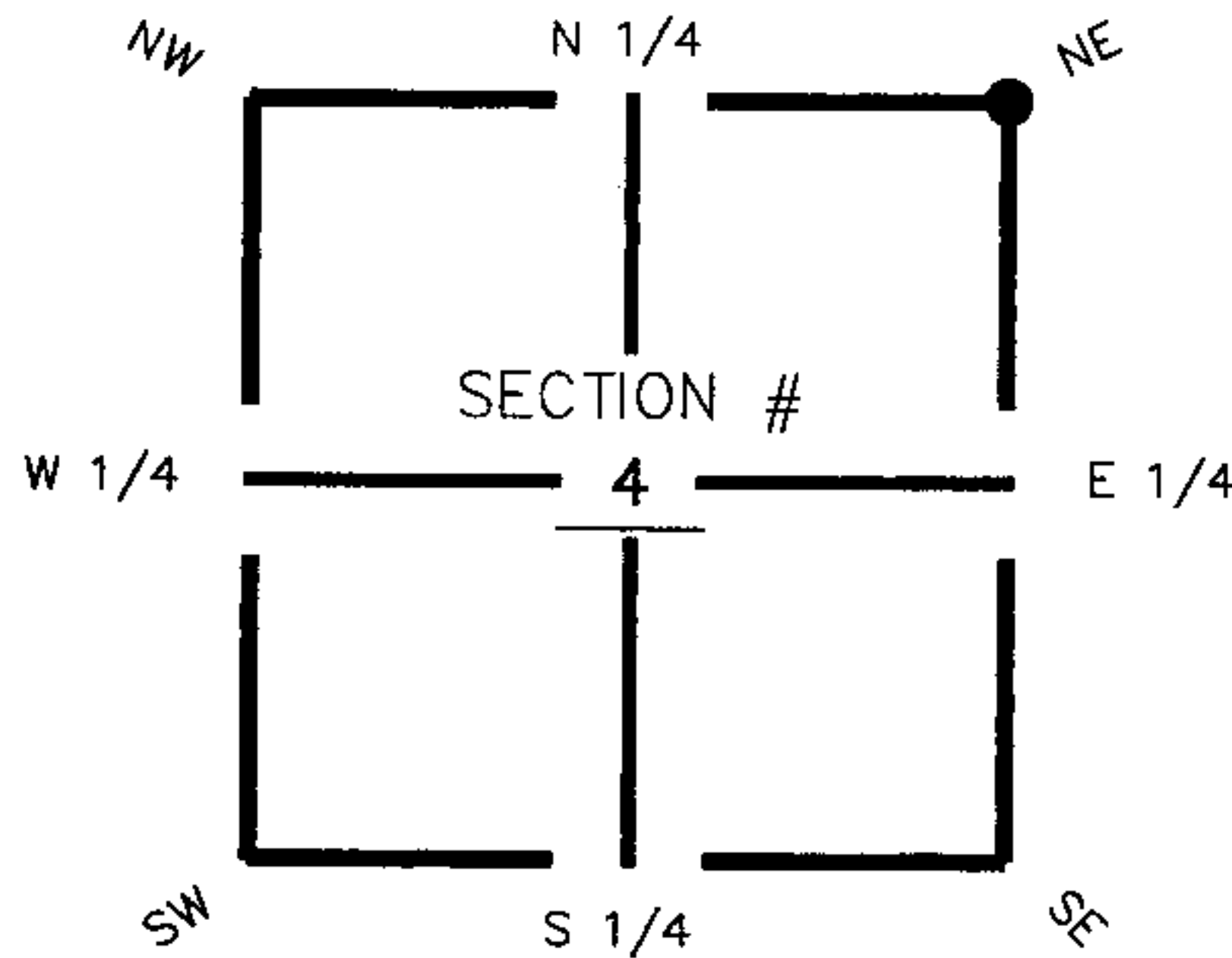

Set  $\frac{3}{4}$ " Iron Pipe & Cap  
(LB 642)

**HORIZONTAL POSITION INFORMATION ( if determined ):**

Latitude 26° 51' 25.12374" N Longitude 81° 36' 48.76919" W  
 Y(NORTHING-Ft.) 917374.82 X(EASTING-Ft.) 782162.71 Zone FL83-WF  
 Convergence 0° 10' 28.51705" Scale factor 0.999959377

NE corner of Section 4  
 Twp 42 South , Rge 27 East  
 Tallahassee Base Meridian,  
Charlotte County(s), Florida

Coordinate determination (circle one):      Field traverse (GPS)  
 Horizontal datum (circle one):      NAD27    NAD83(1986)    NAD83(1999)    other (explain)  
 Accuracy (circle one):      1st    2nd    3rd    other \_\_\_\_\_

1. 323° 69.99'. Set PK Nail and Trav. Pt. Disc (LB 642) in E. face of 14" Pine.
2. 258° 93.73'. Set PK Nail and Trav. Pt. Disc (LB 642) in E. face 12" Pine.
3. 203° 70.31'. Set PK Nail and Trav. Pt. Disc (LB 642) in E. face of 14" Pine.

N.E. Cor Sec.4, Twp.42S., Rge.27E.  
 Set  $\frac{3}{4}$ " Iron Pipe & Cap, 40.3'W. of  
 N.-S. fence line.  
 (LB 642).

Field Book: LB-33, Page 49

**SURVEYORS CERTIFICATE:**

I certify the monument and accessories indicated above were field located on November 11, 2005

*[Signature]*  
 SIGNATURE \_\_\_\_\_ 4912  
 Johnson Engineering, Inc. PSM NO.  
 FIRM OR AGENCY \_\_\_\_\_ 642  
 251 West Hickpochee (SR80) LB NO.  
 ADDRESS \_\_\_\_\_  
 La Belle, Florida 33935  
 CITY, STATE, ZIP  
 (863) 612-0594 August 10, 2006  
 PHONE NUMBER DATE

SEND ORIGINAL TO:  
 Department of Environmental Protection  
 Bureau of Surveying and Mapping  
 3900 Commonwealth Boulevard  
 Mail Station 105  
 Tallahassee, Florida 32399

D.E.P. USE ONLY	
Processed: <u>11-13-06</u>	<u>MP</u>
B.L.M. - I.D. <u>397700</u>	
QUAD - I.D. <u>2313 Telegraphswamp SE</u>	

EMBOSSSED SEAL OVER SIGNATURE