

**FLORIDA DEPARTMENT OF ENVIRONMENTAL PROTECTION**  
**CERTIFIED CORNER RECORD**

089367

DOC. # \_\_\_\_\_

**CORNER DESCRIPTION:**      **MONUMENTATION DESCRIPTION (EVIDENCE FOUND OR METHOD TO SET)**

Depict corner with  A-21

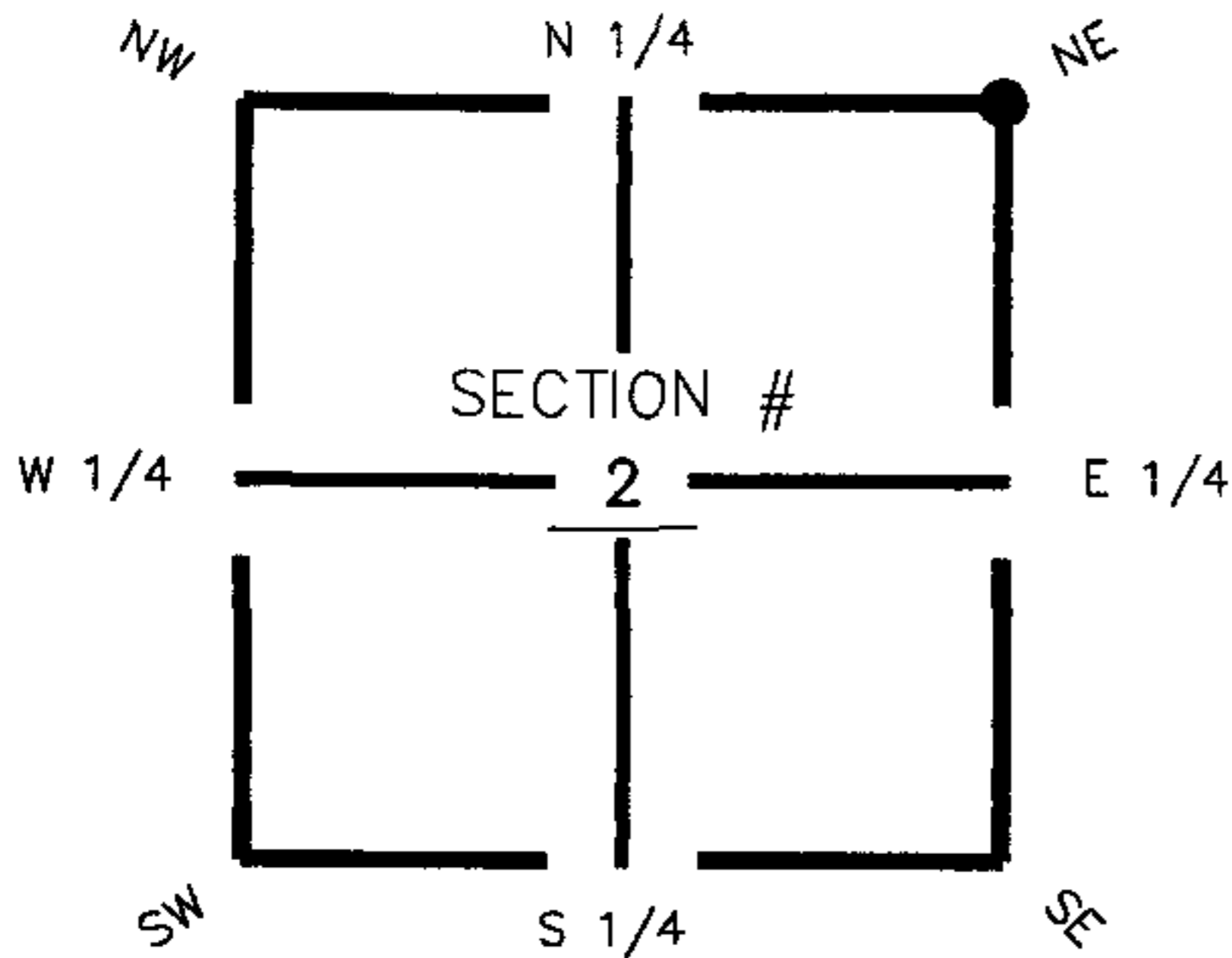

Set  $\frac{3}{4}$ " Iron Pipe & Cap  
(LB 642)

**HORIZONTAL POSITION INFORMATION ( if determined ):**

Latitude 26° 51' 24.57795" N Longitude 81° 34' 51.54269" W  
 Y(NORTHING-Ft.) 917353.42 X(EASTING-Ft.) 792779.56 Zone FL83-WF  
 Convergence 0° 11' 21.47443" Scale factor 0.999962574  
 Coordinate determination (circle one):      Field traverse (GPS)  
 Horizontal datum (circle one):      NAD27      NAD83(1986)      NAD83(1999) other (explain)  
 Accuracy (circle one):      1st      (2nd)      3rd      other \_\_\_\_\_

NE corner of Section 2  
 Twp 42 South , Rge 27 East  
 Tallahassee Base Meridian,  
Charlotte County(s), Florida

1. 23° 39.14'. Set PK Nail and Trav. Pt. Disc (LB 642) in W. face of 12" Pine.
2. 130° 39.18'. Set PK Nail and Trav. Pt. Disc (LB 642) in W. face 12" Pine.
3. 273° 12.77'. Set PK Nail and Trav. Pt. Disc (LB 642) in S. face of 10" Pine.

N.E. Cor Sec.2, Twp.42S., Rge.27E.  
Set  $\frac{3}{4}$ " Iron Pipe & Cap (LB 642).

Field Book: LB-33, Page 51

The map shows a grid of sections. Section 2 is at the bottom left, Section 1 at the bottom right, Section 3 at the top left, and Sections 35 and 36 at the top. A vertical dashed line separates sections 35/36 from 2/1. A horizontal dashed line separates sections 3/2 from 35/36. A solid line labeled 'Woods Trail' runs from the top left towards the bottom right. Township 41 South and Township 42 South are indicated by horizontal dashed lines. Monument locations are marked with circles containing numbers 1, 2, and 3. A north arrow and 'NOT TO SCALE' are on the right.

**SURVEYORS CERTIFICATE:**

I certify the monument and accessories indicated above were field located on November 11, 2005

*[Signature]*  
 \_\_\_\_\_  
 SIGNATURE  
 Johnson Engineering, Inc.  
 \_\_\_\_\_  
 FIRM OR AGENCY  
 251 West Hickpochee (SR80)  
 \_\_\_\_\_  
 ADDRESS  
 La Belle Florida 33935  
 \_\_\_\_\_  
 CITY STATE ZIP  
 (863) 612-0594 August 10, 2006  
 \_\_\_\_\_  
 PHONE NUMBER DATE

EMBOSSSED SEAL OVER SIGNATURE

SEND ORIGINAL TO:  
 Department of Environmental Protection  
 Bureau of Surveying and Mapping  
 3900 Commonwealth Boulevard  
 Mail Station 105  
 Tallahassee, Florida 32399

Processed:	D.E.P. USE ONLY <u>11-13-06 MB</u>
B.L.M. - I.D.	<u>603700</u>
QUAD - I.D.	<u>2313 Telegraph Swamp SE</u>