

FLORIDA DEPARTMENT OF ENVIRONMENTAL PROTECTION

CERTIFIED CORNER RECORD

DOC. # 089375

CORNER DESCRIPTION: MONUMENTATION DESCRIPTION (EVIDENCE FOUND OR METHOD TO SET)

Depict corner with C-1

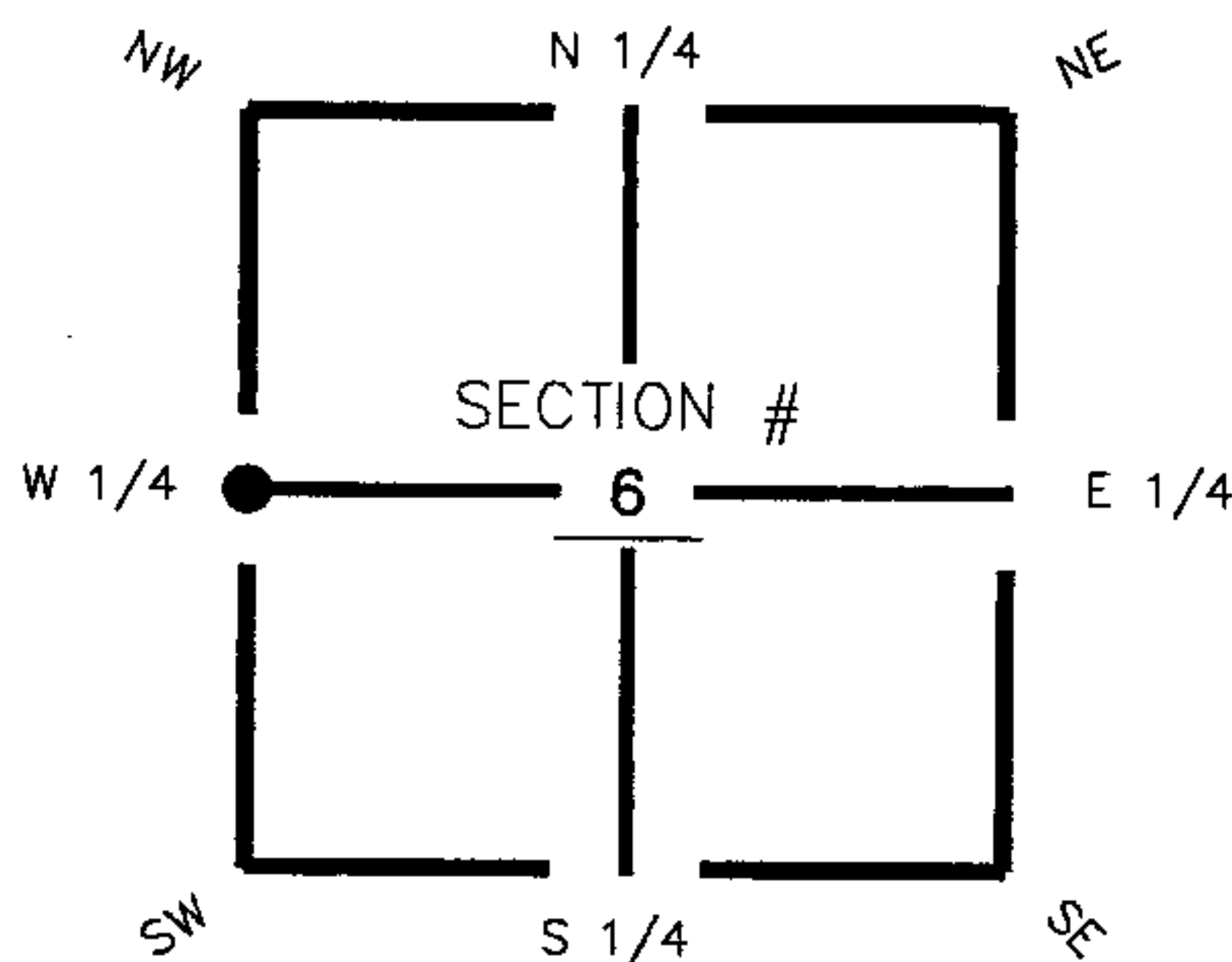

Set $\frac{3}{4}$ " Pipe

HORIZONTAL POSITION INFORMATION (if determined):

Latitude 26° 50' 59.39625" N Longitude 81° 39' 44.94703" W
 Y(NORTHING-Ft.) 914731.50 X(EASTING-Ft.) 766214.06 Zone FL83-WF
 Convergence 0° 09' 08.78829" Scale factor 0.999955061

W 1/4 corner of Section 6
 Twp 42 South , Rge 27 East
 Tallahassee Base Meridian,
Charlotte County(s), Florida

Coordinate determination (circle one): Field traverse GPS
 Horizontal datum (circle one): NAD27 NAD83(1986) NAD83(1999) other (explain)
 Accuracy (circle one): 1st 2nd 3rd other _____

1. 305° 70.46'. Set PK Nail and Trav. Pt. Disc (LB 642) in N. face of 10" Pine Tree.
2. 340° 78.83'. Set PK Nail and Trav. Pt. Disc (LB 642) in N.E. face of 10" Pine Tree.
3. 15° 98.42'. Set PK Nail and Trav. Pt. Disc (LB 642) in W. face of 9" Pine Tree.

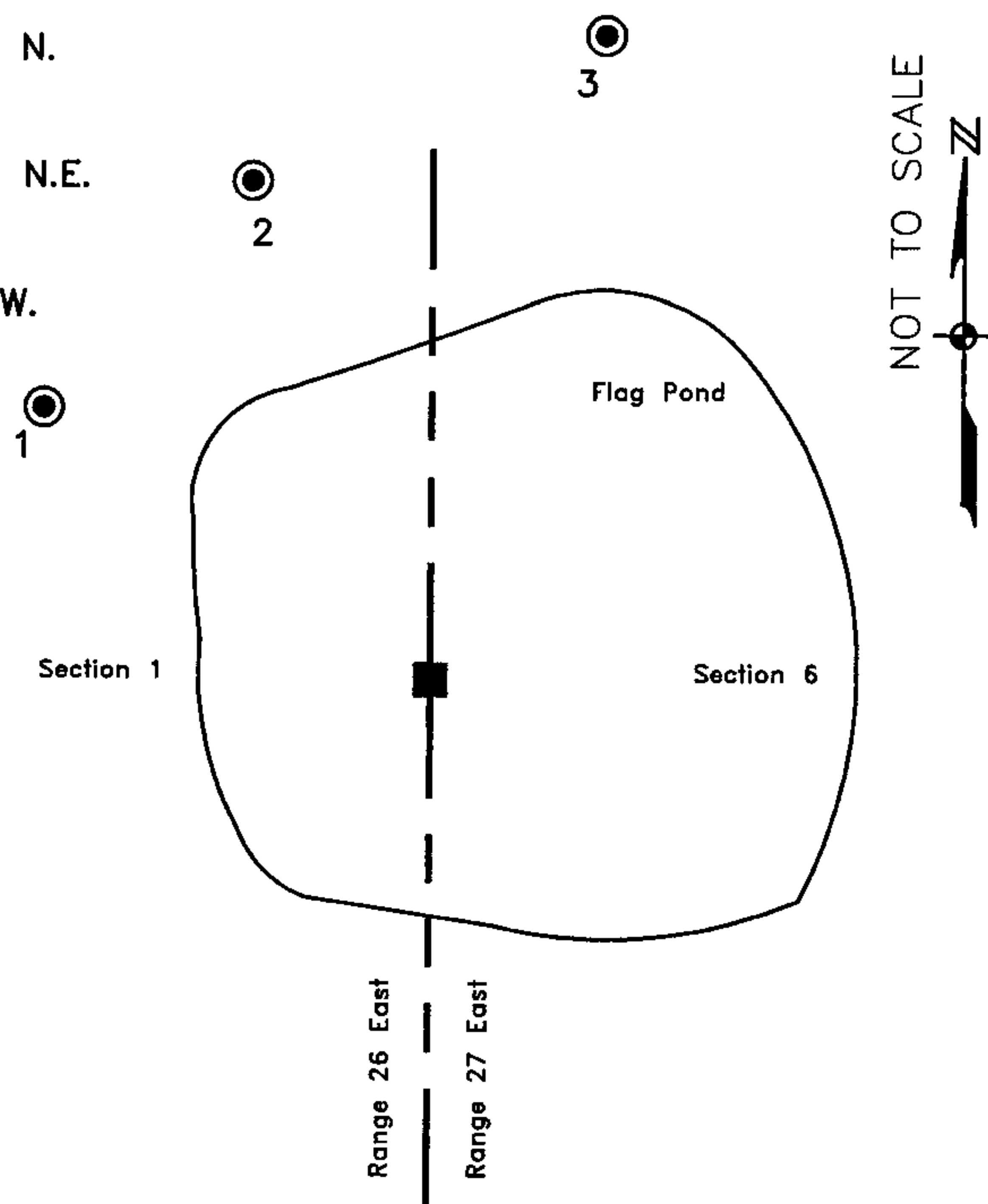

W 1/4 Sec. 6, Twp. 42S., Rge. 27E.
 Set $\frac{3}{4}$ " Pipe.

Field Book: LB-33, Page 33

SURVEYORS CERTIFICATE:

I certify the monument and accessories indicated above were field located on November 4, 2005

[Signature]
 SIGNATURE _____ 4912
 Johnson Engineering, Inc. PSM NO. _____
 251 West Hickpochee (SR80) ADDRESS _____ 642
 La Belle, Florida 33935 LB NO. _____
 (863) 612-0594 PHONE NUMBER _____
 November 8, 2005 DATE _____

SEND ORIGINAL TO:
 Department of Environmental Protection
 Bureau of Surveying and Mapping
 3900 Commonwealth Boulevard
 Mail Station 105
 Tallahassee, Florida 32399

D.E.P. USE ONLY

Processed: 11-13-06 MB
 B.L.M. - I.D. 700640
 QUAD - I.D. 2314 Telegraph Swamp

EMBOSSED SEAL OVER SIGNATURE