

# FLORIDA DEPARTMENT OF ENVIRONMENTAL PROTECTION

## CERTIFIED CORNER RECORD

**089382**

DOC. # \_\_\_\_\_

**CORNER DESCRIPTION:**      **MONUMENTATION DESCRIPTION (EVIDENCE FOUND OR METHOD TO SET)**

Depict corner with  J-21

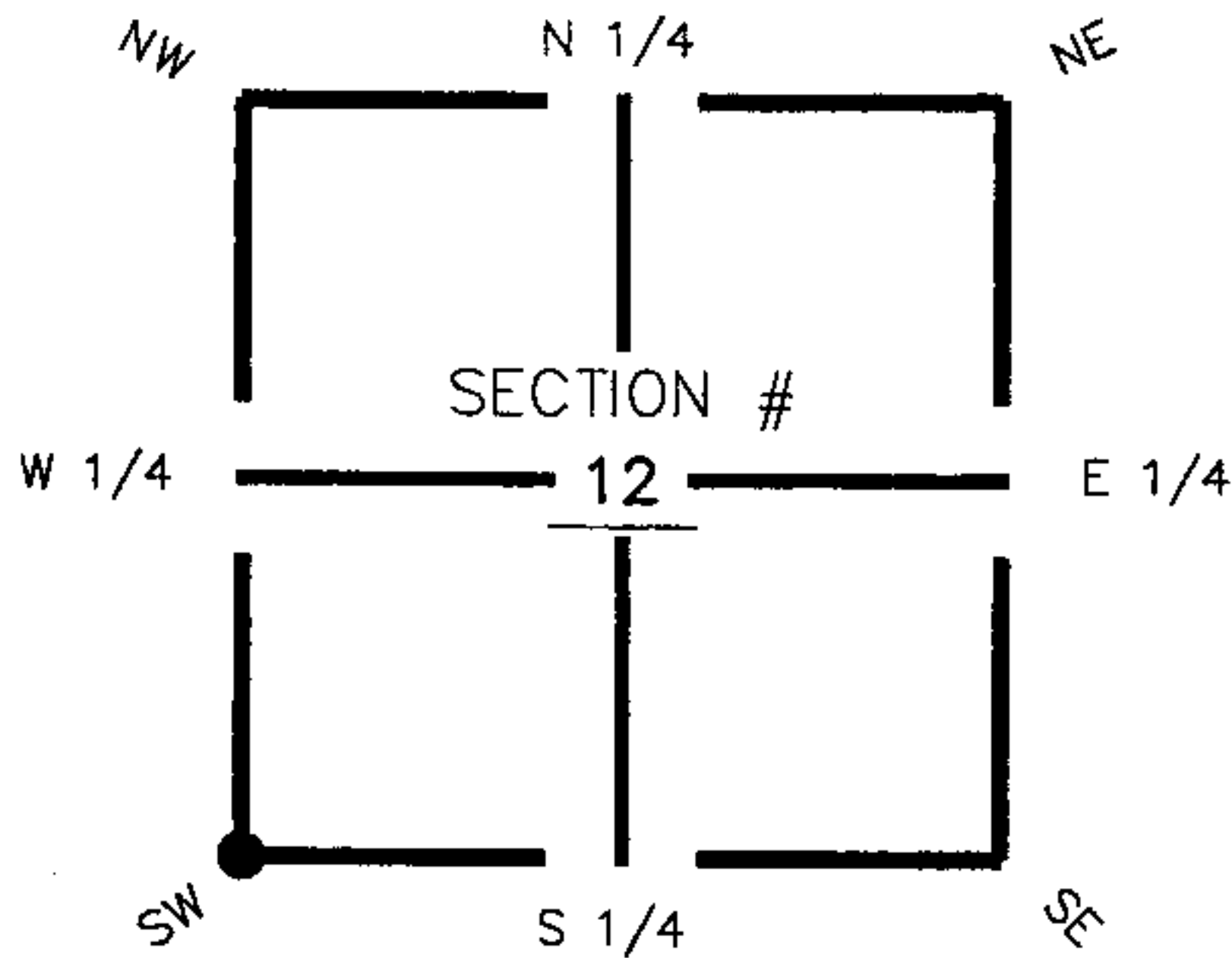

Set  $\frac{3}{4}$ " Iron Pipe & Cap  
(LB 642)

SW corner of Section 12  
Twp 42 South , Rge 27 East  
Tallahassee Base Meridian,  
Charlotte County(s), Florida

**HORIZONTAL POSITION INFORMATION ( if determined ):**

Latitude 26° 49' 40.72815" N Longitude 81° 34' 52.83991" W  
Y(NORTHING-Ft.) 906866.97 X(EASTING-Ft.) 792696.67 Zone FL83-WF  
Convergence 0° 11' 20.21131" Scale factor 0.999962548  
Coordinate determination (circle one):      Field traverse (GPS)  
Horizontal datum (circle one):      NAD27      NAD83(1986)      NAD83(1999) other (explain)  
Accuracy (circle one):      1st      2nd      3rd      other \_\_\_\_\_

1. 64' 48.25'. Set PK Nail and Trav. Pt. Disc (LB 642) in N. face of 5" Pine.
2. 100' 71.84'. Set PK Nail and Trav. Pt. Disc (LB 642) in N. face of fence post.
3. 256' 40.45'. Set PK Nail and Trav. Pt. Disc (LB 642) in N. face of 12" Pine.

NOT TO SCALE

S.W. Cor. Sec.12, Twp.42S., Rge.27E.  
Set  $\frac{3}{4}$ " Iron Pipe & Cap  
(LB 642).

Field Book: LB-33, Page 39

**SURVEYORS CERTIFICATE:**

I certify the monument and accessories indicated above were field located on November 8, 2005

*[Signature]*  
 \_\_\_\_\_  
 SIGNATURE      4912  
 Johnson Engineering, Inc.      PSM NO.  
 \_\_\_\_\_      642  
 FIRM OR AGENCY      LB NO.  
 251 West Hickpochee (SR80)  
 \_\_\_\_\_  
 ADDRESS  
 La Brea      Florida      33935  
 \_\_\_\_\_  
 CITY      STATE      ZIP  
 (863) 612-0594      December 2, 2005  
 \_\_\_\_\_  
 PHONE NUMBER      DATE

SEND ORIGINAL TO:  
 Department of Environmental Protection  
 Bureau of Surveying and Mapping  
 3900 Commonwealth Boulevard  
 Mail Station 105  
 Tallahassee, Florida 32399

D.E.P. USE ONLY

Processed: 11-13-06 MB

B.L.M. - I.D. 600500

QUAD - I.D. 2313 Telegraph Swamp SE

EMBOSSSED SEAL OVER SIGNATURE