

FLORIDA DEPARTMENT OF ENVIRONMENTAL PROTECTION  
CERTIFIED CORNER RECORD

DOC. # 089385

CORNER DESCRIPTION:      MONUMENTATION DESCRIPTION (EVIDENCE FOUND OR METHOD TO SET)

Depict corner with  P-25

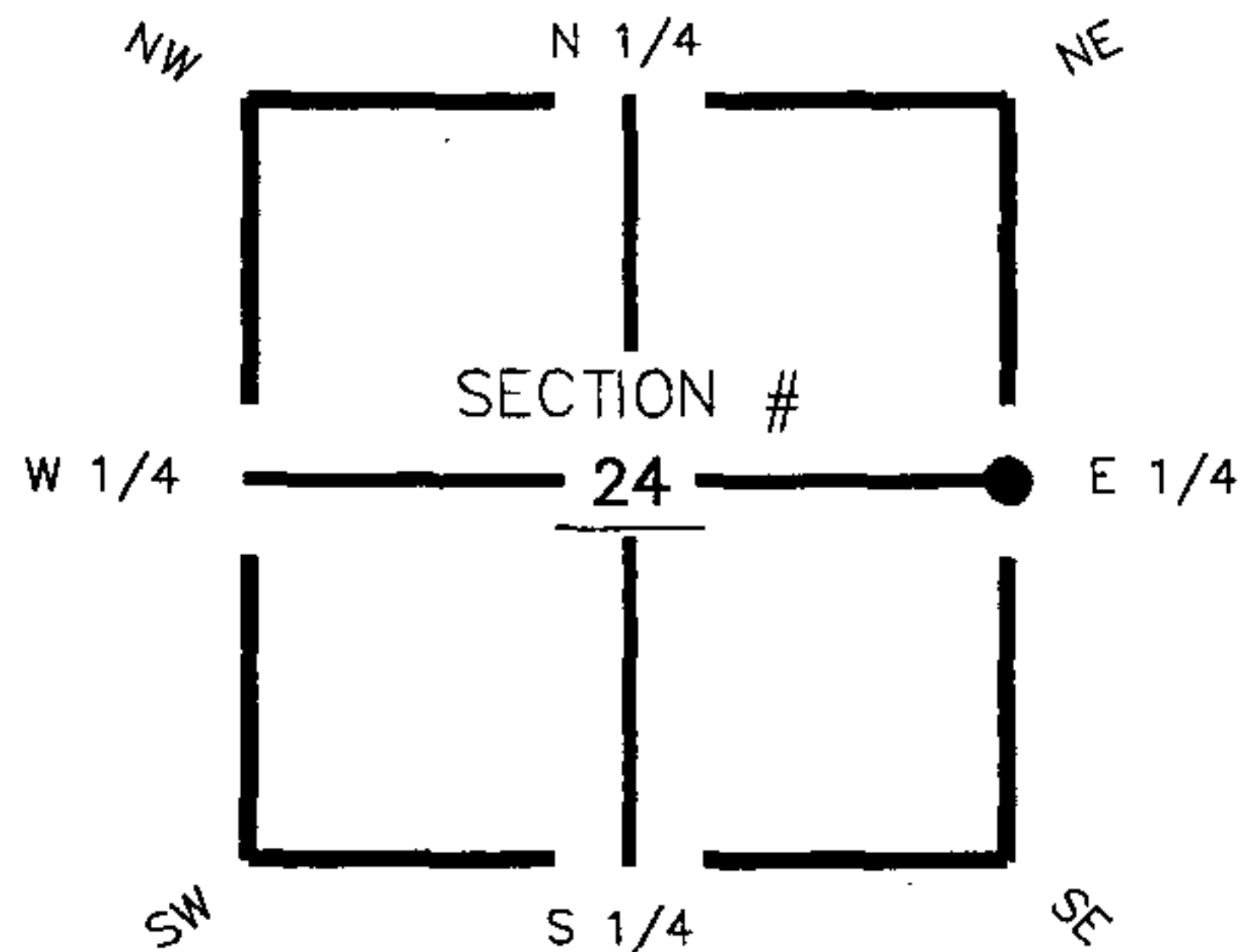

Found Lt. Wood Post

E 1/4 corner of Section 24  
Twp 42 South, Rge 27 East  
Tallahassee Base Meridian,  
Charlotte County(s), Florida

HORIZONTAL POSITION INFORMATION ( if determined ):

Latitude 26° 48' 21.95393" N Longitude 81° 33' 55.15974" W  
Y(NORTHING-Ft.) 898930.45 X(EASTING-Ft.) 797949.06 Zone FL83-WF  
Convergence 0° 11' 45.71095" Scale factor 0.999964224  
Coordinate determination (circle one):      Field traverse  GPS  
Horizontal datum (circle one):      NAD27      NAD83(1986)       NAD83(1999)      other (explain)  
Accuracy (circle one):      1st       2nd      3rd      other \_\_\_\_\_

1. 69° 89.49'. Set PK Nail and Trav. Pt. Disc (LB 642) in W. face of 12" Pine tree.
2. 123° 86.00'. Set PK Nail and Trav. Pt. Disc (LB 642) in W. face of 20" Pine tree.
3. 203° 1.55'. Set PK Nail and Trav. Pt. Disc (LB 642) in E. face of fence post.

Section 24

E 1/4 Sec.24, Twp.42S., Rge.27E.  
Found Lt. Wood Post (shaped)  
0.4'E. of N.-S. fence line.

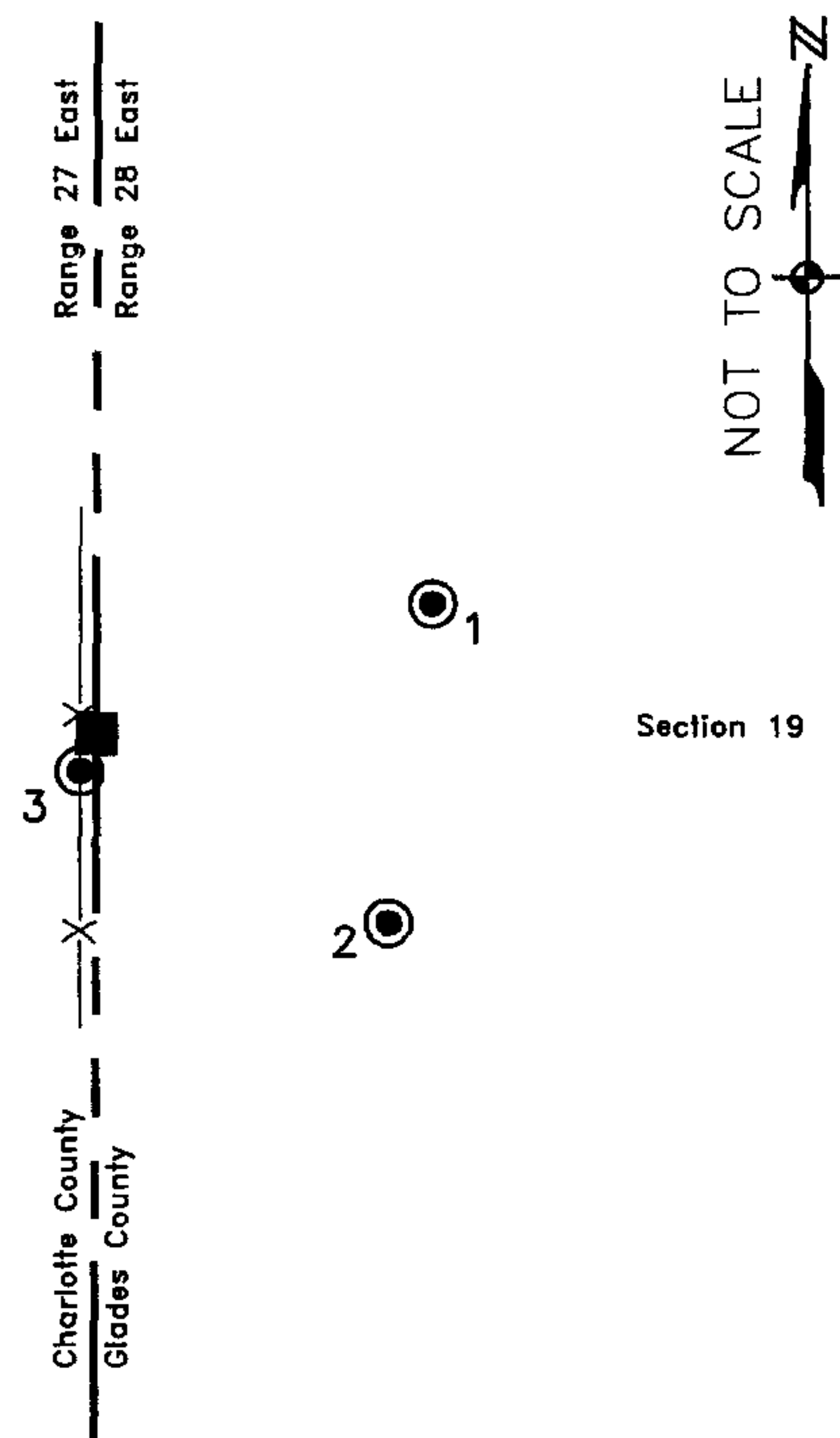

Field Book: LB-31, Page 54

SURVEYORS CERTIFICATE:

I certify the monument and accessories indicated above were field located on Sept. 6, 2005

*[Signature]*  
\_\_\_\_\_  
SIGNATURE      4912  
\_\_\_\_\_  
PSM NO.  
Johnson Engineering, Inc.      642  
\_\_\_\_\_  
FIRM OR AGENCY      LB NO.  
251 West Hickpochee (SR80)  
\_\_\_\_\_  
ADDRESS  
La Belle, Florida      33935  
\_\_\_\_\_  
CITY      STATE      ZIP  
(863) 612-0594      October 31, 2005  
\_\_\_\_\_  
PHONE NUMBER      DATE

EMBOSSSED SEAL OVER SIGNATURE

SEND ORIGINAL TO:  
Department of Environmental Protection  
Bureau of Surveying and Mapping  
3900 Commonwealth Boulevard  
Mail Station 105  
Tallahassee, Florida 32399

D.E.P. USE ONLY

Processed: 11-13-06 YMB  
B.L.M. - I.D. 700340  
QUAD - I.D. 2313 Telegraph Swamp SE