

**FLORIDA DEPARTMENT OF ENVIRONMENTAL PROTECTION
CERTIFIED CORNER RECORD**

089387

DOC. # _____

CORNER DESCRIPTION: MONUMENTATION DESCRIPTION (EVIDENCE FOUND OR METHOD TO SET)

Depict corner with T-25

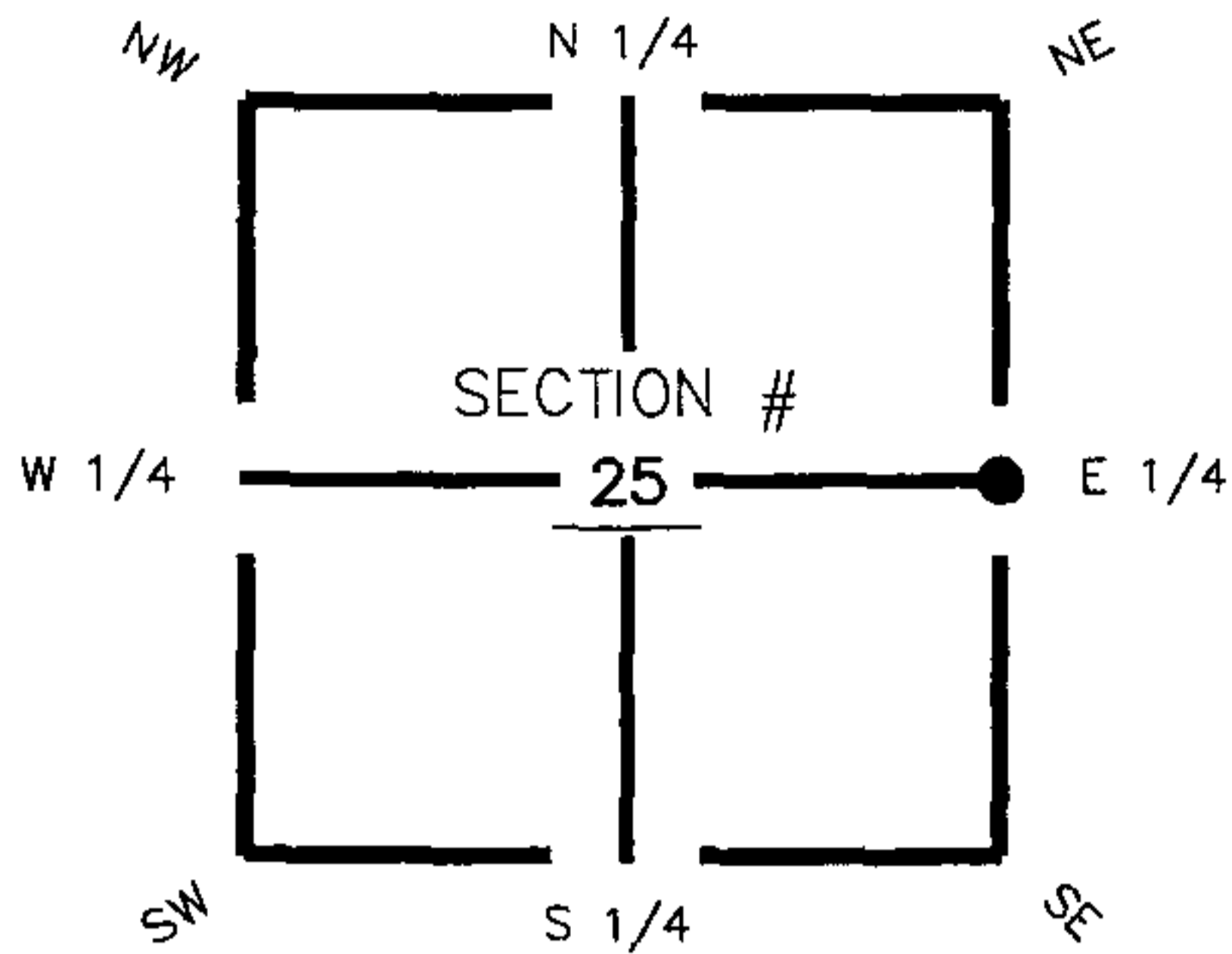

Found 4"x4"
Concrete Monument

HORIZONTAL POSITION INFORMATION (if determined):

Latitude 26° 47' 29.29163" N Longitude 81° 33' 55.85650" W
 Y(NORTHING-Ft.) 893612.77 X(EASTING-Ft.) 797904.11 Zone FL83-WF
 Convergence 0° 11' 45.04025" Scale factor 0.999964209

E 1/4 corner of Section 25
 Twp 42 South , Rge 27 East
 Tallahassee Base Meridian,
Charlotte County(s), Florida

Coordinate determination (circle one): Field traverse GPS
 Horizontal datum (circle one): NAD27 NAD83(1986) NAD83(1999) other (explain)
 Accuracy (circle one): 1st 2nd 3rd other _____

1. 85' 0.75'. Set PK Nail and Trav. Pt. Disc (LB 642) in S. face of fence post.
2. 203' 78.08'. Set PK Nail and Trav. Pt. Disc (LB 642) in E. face of 8" Pine tree.
3. 242' 87.10'. Set PK Nail and Trav. Pt. Disc (LB 642) in E. face of 9" Pine tree.

E 1/4 Sec.25, Twp.42S., Rge.27E.
 Found 4"x4" Concrete Monument
 (bent) 0.5'W. of N.-S. fence line.

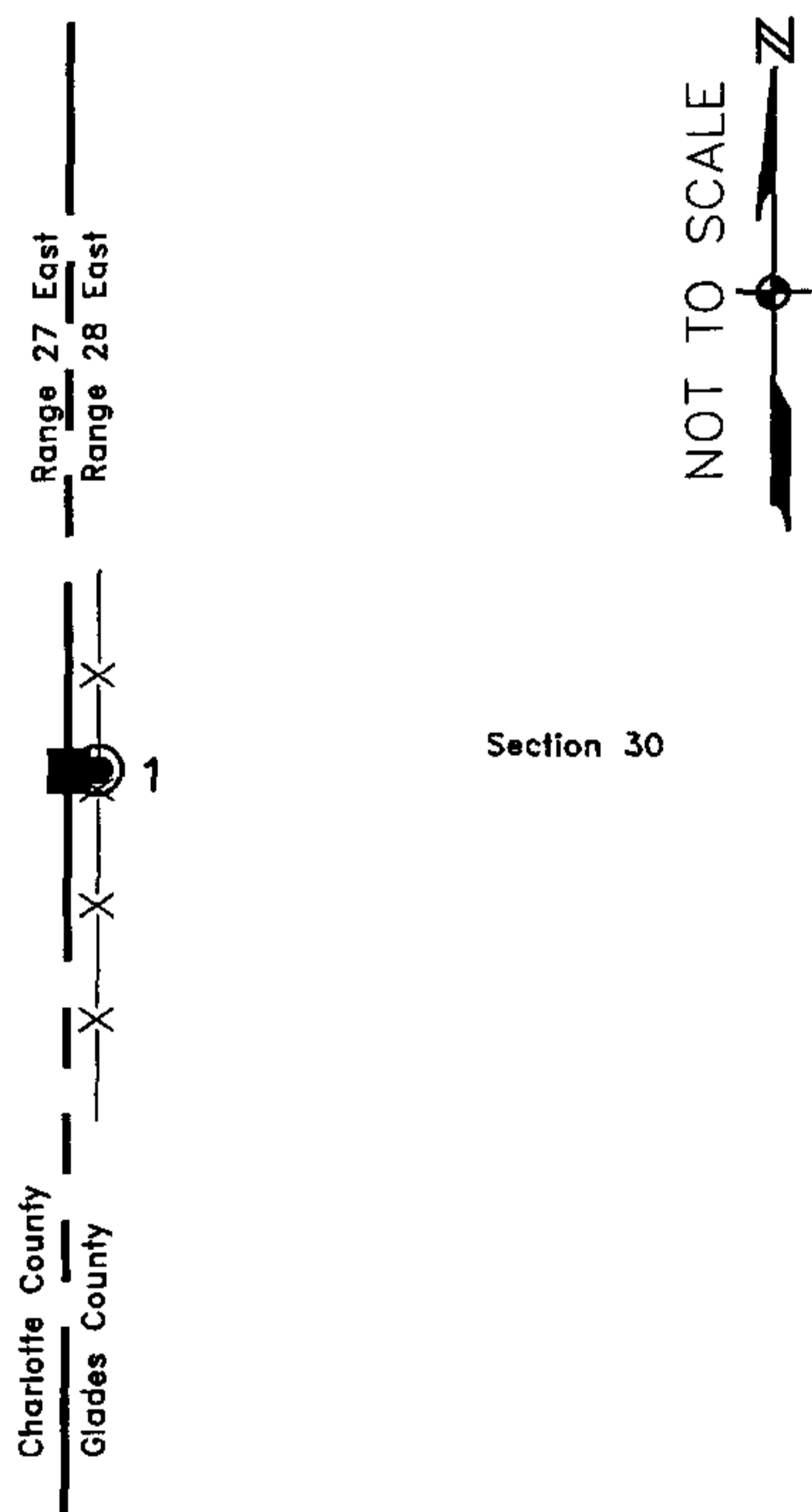

Field Book: LB-31, Page 55

SURVEYORS CERTIFICATE:

I certify the monument and accessories indicated above were field located on Sept. 6, 2005

[Signature]
 SIGNATURE _____ 4912
 JOHNSON ENGINEERING, INC. PSM NO. _____
 FIRM OR AGENCY LB NO. 642
 251 West Hickpochee (SR80) ADDRESS
 La Belle Florida 33935
 CITY STATE ZIP
 (863) 612-0594 November 1, 2005
 PHONE NUMBER DATE

SEND ORIGINAL TO:
 Department of Environmental Protection
 Bureau of Surveying and Mapping
 3900 Commonwealth Boulevard
 Mail Station 105
 Tallahassee, Florida 32399

D.E.P. USE ONLY

Processed: 11-13-06 NIB
 B.L.M. - I.D. 700240
 QUAD - I.D. 2313 Telegraph Swamp SE

EMBOSSSED SEAL OVER SIGNATURE