

FLORIDA DEPARTMENT OF ENVIRONMENTAL PROTECTION CERTIFIED CORNER RECORD

089393

DOC. # _____

CORNER DESCRIPTION: MONUMENTATION DESCRIPTION (EVIDENCE FOUND OR METHOD TO SET)

Depict corner with X-25

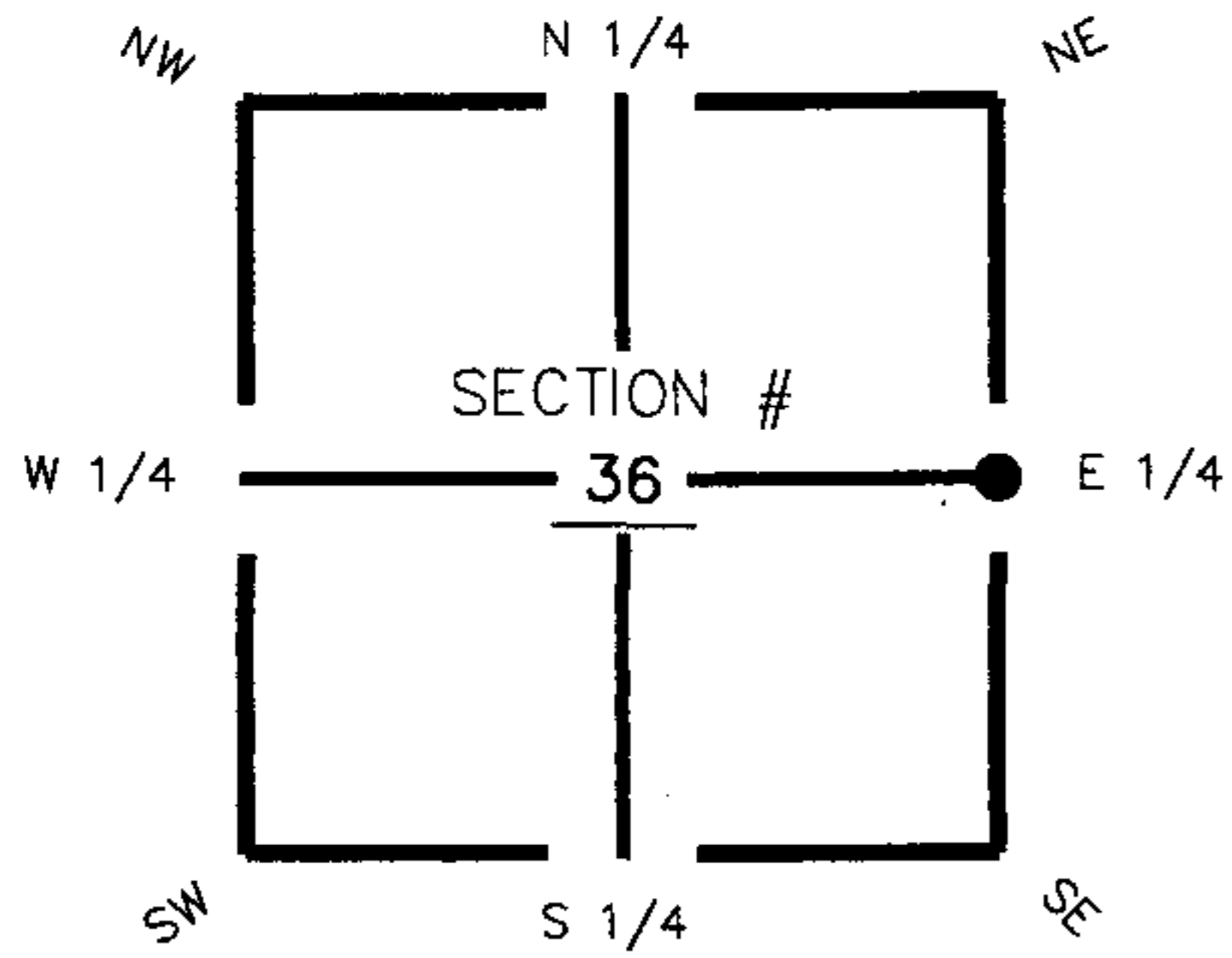

Found Lt. Wood Post

E 1/4 corner of Section 36
Twp 42 South, Rge 27 East
Tallahassee Base Meridian,
Charlotte County(s), Florida

HORIZONTAL POSITION INFORMATION (if determined):

Latitude 26° 46' 36.65794" N Longitude 81° 33' 56.61521" W

Y(NORTHING-Ft.) 888297.97 X(EASTING-Ft.) 797853.51 Zone FL83-WF

Convergence 0° 11' 44.34212" Scale factor 0.999964193

Coordinate determination (circle one): Field traverse GPS

Horizontal datum (circle one): NAD27 NAD83(1986) NAD83(1999) other (explain)

Accuracy (circle one): 1st 2nd 3rd other _____

1. 96° 15.18'. Set PK Nail and Trav. Pt. Disc (LB 642) in W. face of fence post.
2. 190° 61.75'. Set PK Nail and Trav. Pt. Disc (LB 642) in E. face of 18" Pine tree.
3. 358° 28.35'. Set PK Nail and Trav. Pt. Disc (LB 642) in W. face of 18" Pine tree.

E 1/4 Sec.36, Twp.42S., Rge.27E.
Found Lt. Wood Post 2.5'E. of
N.-S. fence line.

Field Book: LB-31, Page 56

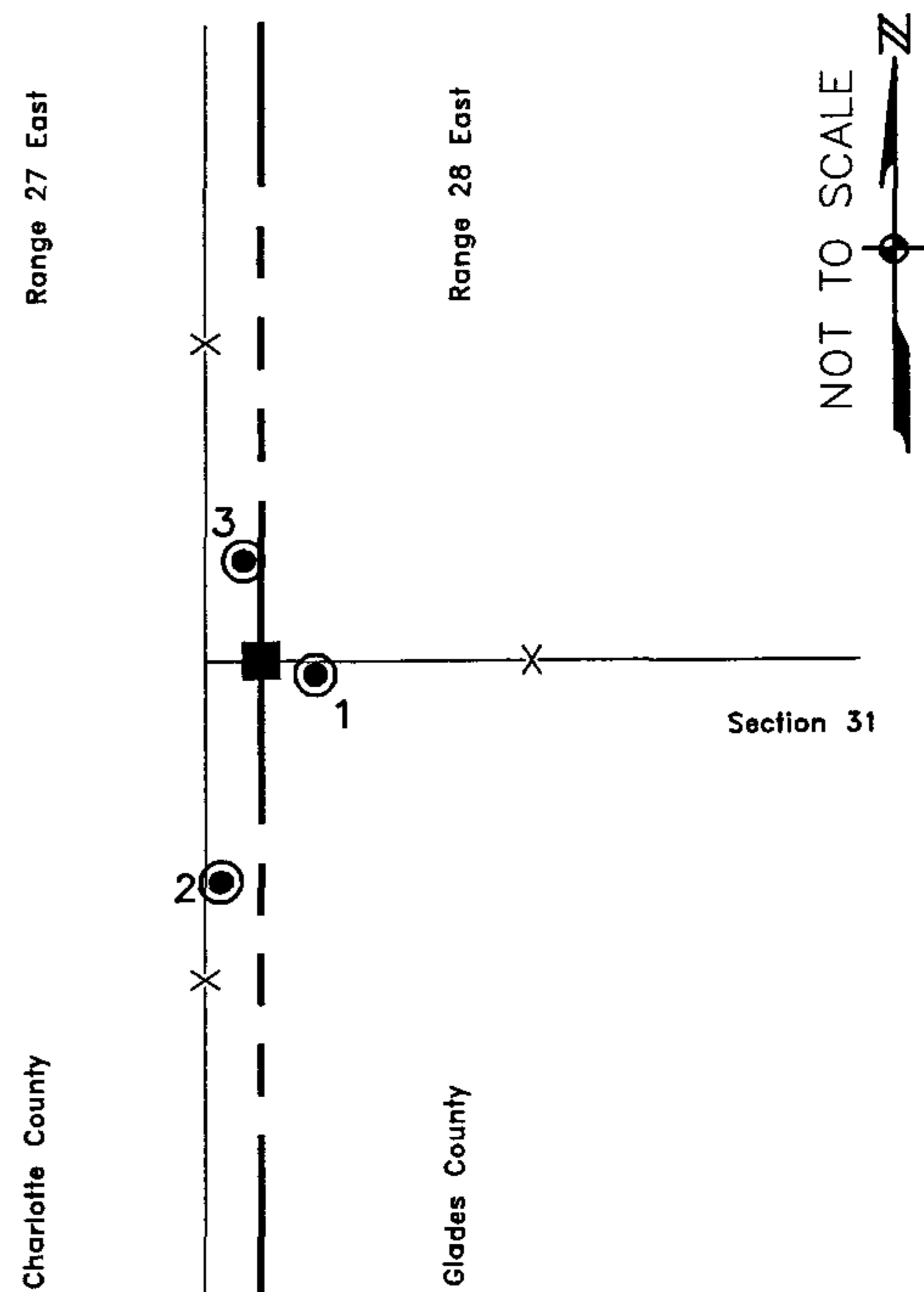

SURVEYORS CERTIFICATE:

I certify the monument and accessories indicated above were field located on Sept. 6, 2005

[Signature]
 SIGNATURE _____ PSM NO. 4912
 Johnson Engineering, Inc. _____ FIRM OR AGENCY _____ LB NO. 642
 251 West Hickory Ave (SR80) _____ ADDRESS _____
 La Belle, Florida 33935 _____ CITY STATE ZIP
 (863) 612-0594 _____ PHONE NUMBER _____
 November 1, 2005 _____ DATE

SEND ORIGINAL TO:
 Department of Environmental Protection
 Bureau of Surveying and Mapping
 3900 Commonwealth Boulevard
 Mail Station 105
 Tallahassee, Florida 32399

D.E.P. USE ONLY

Processed: 11-13-06 MB

B.L.M. - I.D. 700140

QUAD - I.D. 2313 Telegraph Swamp SE

EMBOSSSED SEAL OVER SIGNATURE