

**FLORIDA DEPARTMENT OF ENVIRONMENTAL PROTECTION
CERTIFIED CORNER RECORD**

089388

DOC. # _____

CORNER DESCRIPTION: MONUMENTATION DESCRIPTION (EVIDENCE FOUND OR METHOD TO SET)

Depict corner with **●** Z-15

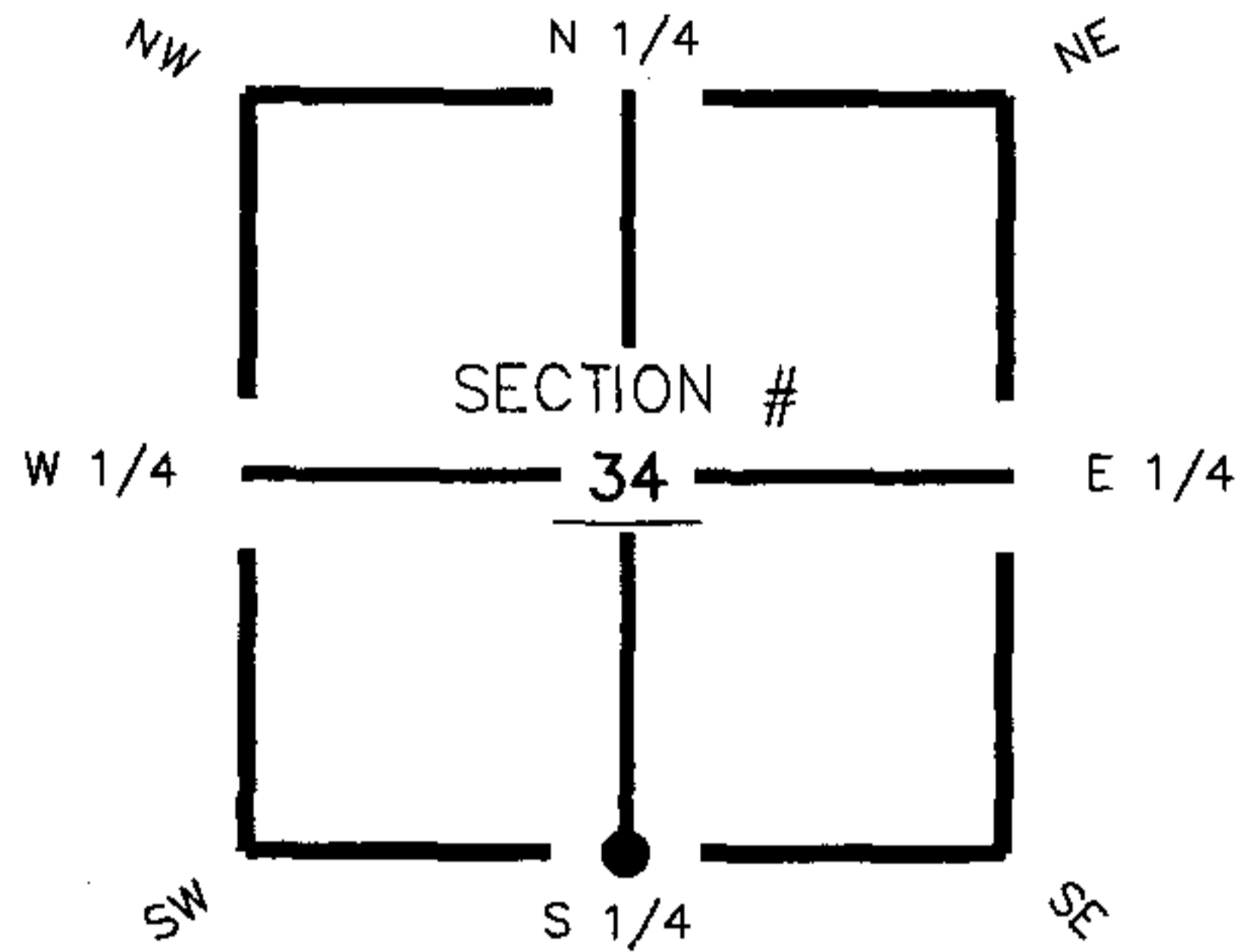

Found Lt. Wood Post

HORIZONTAL POSITION INFORMATION (if determined):

Latitude 26° 46' 09.54822" N Longitude 81° 36' 23.82044" W
 Y(NORTHING-Ft.) 885517.23 X(EASTING-Ft.) 784520.89 Zone FL83-WF
 Convergence 0° 10' 37.85470" Scale factor 0.999960065
 Coordinate determination (circle one): Field traverse (GPS)
 Horizontal datum (circle one): NAD27 NAD83(1986) (NAD83(1999)) other (explain) _____
 Accuracy (circle one): 1st (2nd) 3rd other _____

S 1/4 corner of Section 34
 Twp 42 South , Rge 27 East
 Tallahassee Base Meridian,
Charlotte County(s), Florida

1. 353' 39.84'. Set PK Nail and Trav. Pt. Disc (LB 642) in E. face of 7" Pine tree.
2. 17' 45.14'. Set PK Nail and Trav. Pt. Disc (LB 642) in W. face of 5" Pine tree.
3. 356' 1.32'. Set PK Nail and Trav. Pt. Disc (LB 642) in E. face of fence post.

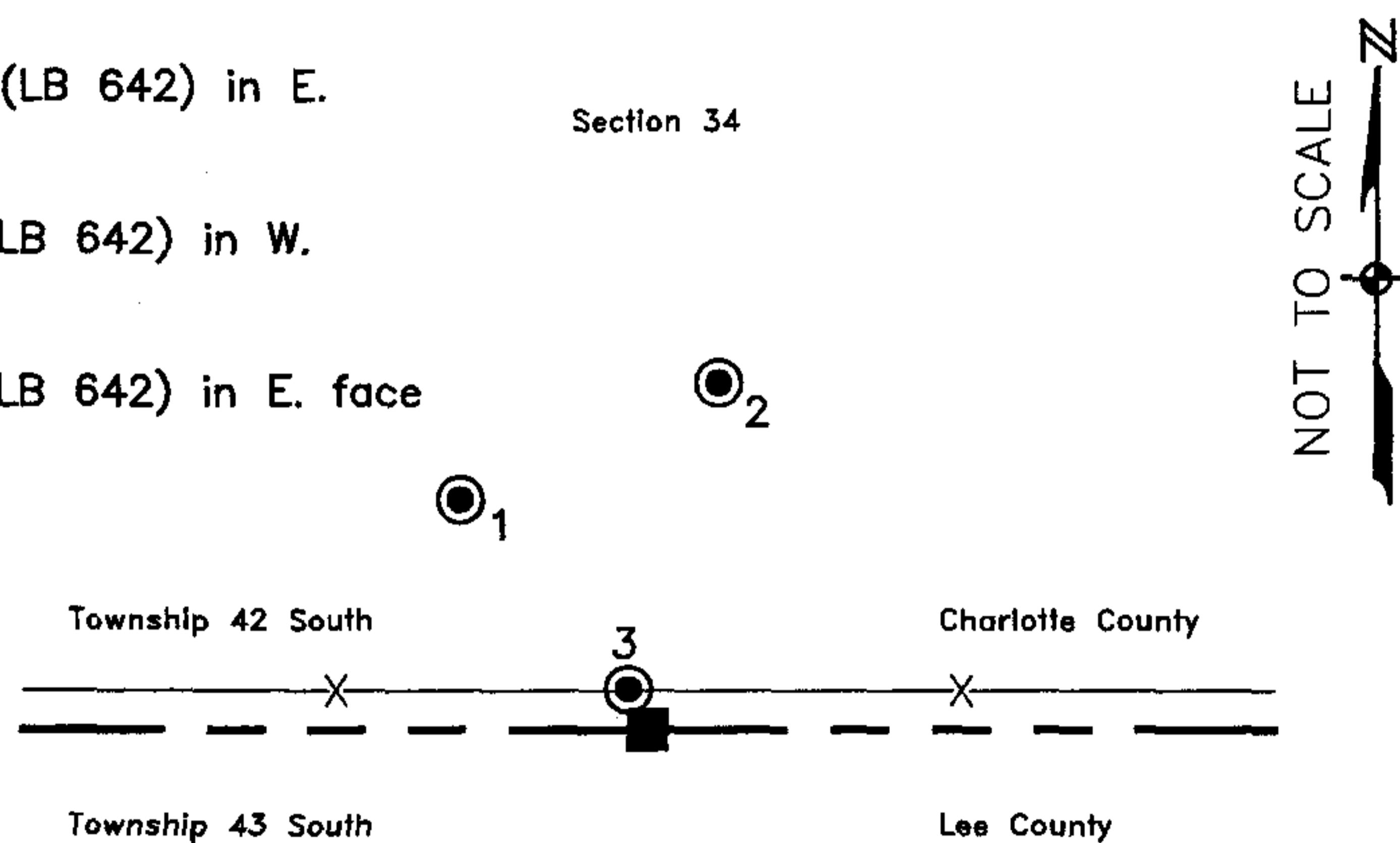

S 1/4 Sec.34, Twp.42S., Rge.27E.
 Found Lt. Wood Post
 1.32'S. of E.-W. fence line.

Section 3

Field Book: LB-31, Page 62

SURVEYORS CERTIFICATE:

I certify the monument and accessories indicated above were field located on Sept. 7, 2005

[Signature]
 SIGNATURE _____ PSM NO. 4912
 Johnson Engineering, Inc. _____ LB NO. 642
 FIRM OR AGENCY
 231 West Hill Ocoee (SR80) _____
 ADDRESS
 La. Belle _____ Florida 33935
 CITY STATE ZIP
 (863) 612-0594 _____ November 1, 2005
 PHONE NUMBER DATE

SEND ORIGINAL TO:
 Department of Environmental Protection
 Bureau of Surveying and Mapping
 3900 Commonwealth Boulevard
 Mail Station 105
 Tallahassee, Florida 32399

D.E.P. USE ONLY

Processed: 11-13-06 MB

B.L.M. - I.D. 440100

QUAD - I.D. 2313 Telegraph Swamp SE

EMBOSSED SEAL OVER SIGNATURE