

FLORIDA DEPARTMENT OF ENVIRONMENTAL PROTECTION CERTIFIED CORNER RECORD

089390

DOC. # _____

CORNER DESCRIPTION: MONUMENTATION DESCRIPTION (EVIDENCE FOUND OR METHOD TO SET)

Depict corner with Z-19

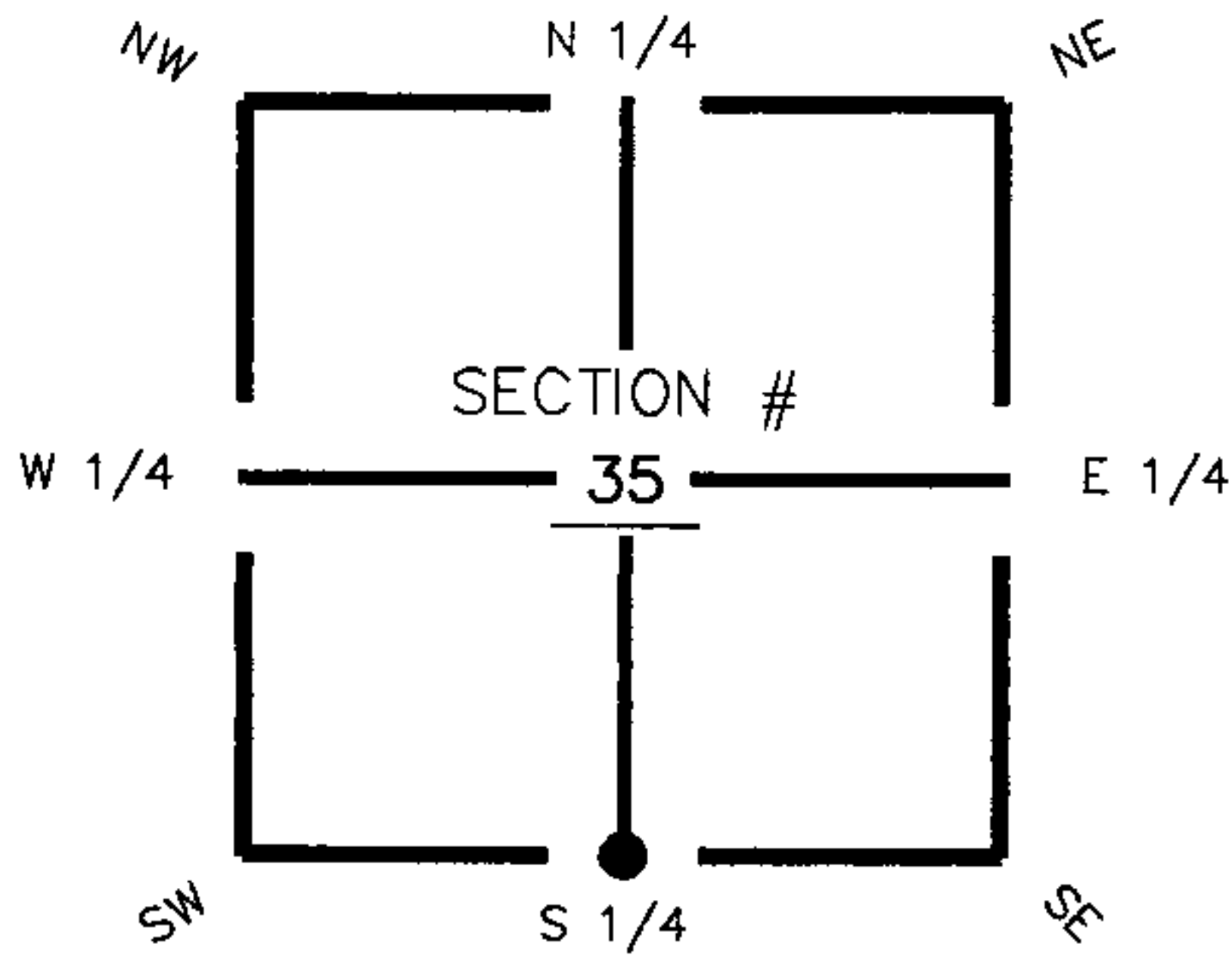

Found Lt. Wood Post

HORIZONTAL POSITION INFORMATION (if determined):

Latitude 26° 46' 09.80715" N Longitude 81° 35' 25.18304" W
 Y(NORTHING-Ft.) 885560.15 X(EASTING-Ft.) 789835.41 Zone FL83-WF
 Convergence 0° 11' 04.26766" Scale factor 0.999961662
 Coordinate determination (circle one): Field traverse (GPS)
 Horizontal datum (circle one): NAD27 NAD83(1986) (NAD83(1999)) other (explain)
 Accuracy (circle one): 1st (2nd) 3rd other _____

S 1/4 corner of Section 35
Twp 42 South , Rge 27 East
 Tallahassee Base Meridian,
Charlotte County(s), Florida

1. 276° 1.63'. Set PK Nail and Trav. Pt. Disc (LB 642) in S. face of fence post.
2. 110° 15.15'. Set 60d Nail and Trav. Pt. Disc (LB 642) in N. face of Pepper Berry tree stump.
3. 236° 9.25'. Set 60d Nail and Trav. Pt. Disc (LB 642) in N. face of Pepper Berry tree stump.

Section 35

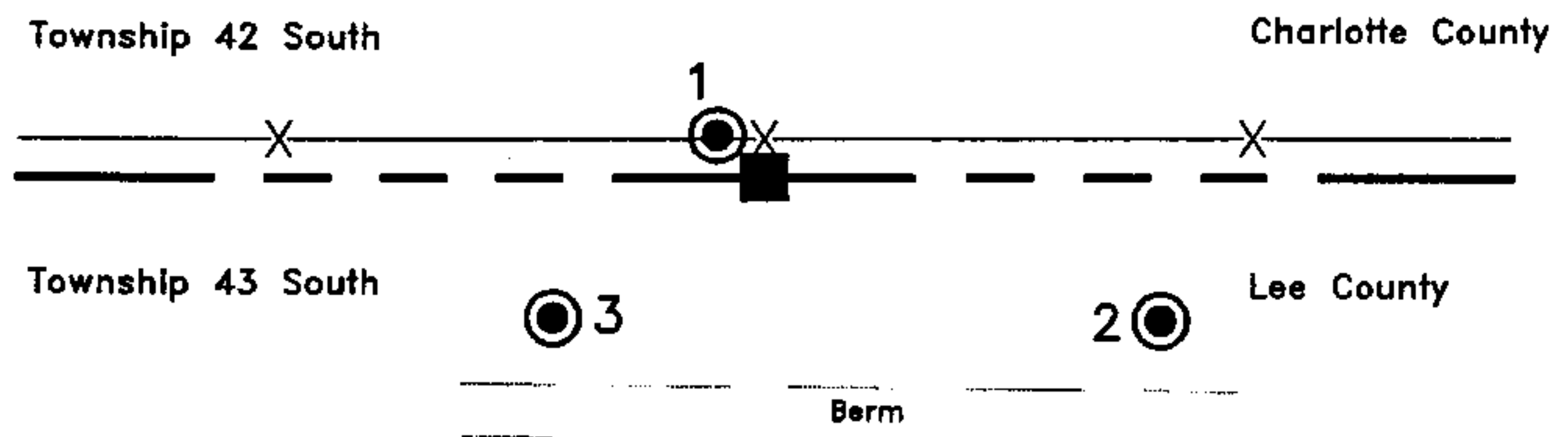
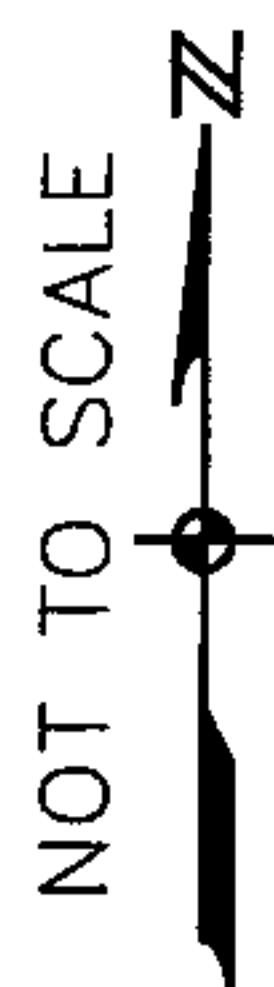

S 1/4 Sec.35, Twp.42S., Rge.27E.
 Found Lt. Wood Post
 0.3'S. of E.-W. fence line.

Field Book: LB-31, Page 57

Section 2

SURVEYORS CERTIFICATE:

I certify the monument and accessories indicated above were field located on Sept. 6, 2005

[Signature]
 SIGNATURE _____ 4912
 Johnson Engineering, Inc. PSM NO. _____
 FIRM OR AGENCY _____ 642
 251 West Hickpochee (SR80) LB NO. _____
 ADDRESS _____
 La Belle Florida 33935
 CITY STATE ZIP
 (863) 612-0594 November 1, 2005
 PHONE NUMBER DATE

EMBOSSSED SEAL OVER SIGNATURE

SEND ORIGINAL TO:
 Department of Environmental Protection
 Bureau of Surveying and Mapping
 3900 Commonwealth Boulevard
 Mail Station 105
 Tallahassee, Florida 32399

D.E.P. USE ONLY	
Processed:	<u>11-13-06 MB</u>
B.L.M. - I.D.	<u>540100</u>
QUAD - I.D.	<u>2313 Telegraph Swamp SE</u>