

FLORIDA DEPARTMENT OF ENVIRONMENTAL PROTECTION CERTIFIED CORNER RECORD

DOC. # 089395

CORNER DESCRIPTION: MONUMENTATION DESCRIPTION (EVIDENCE FOUND OR METHOD TO SET)

Depict corner with Z-23

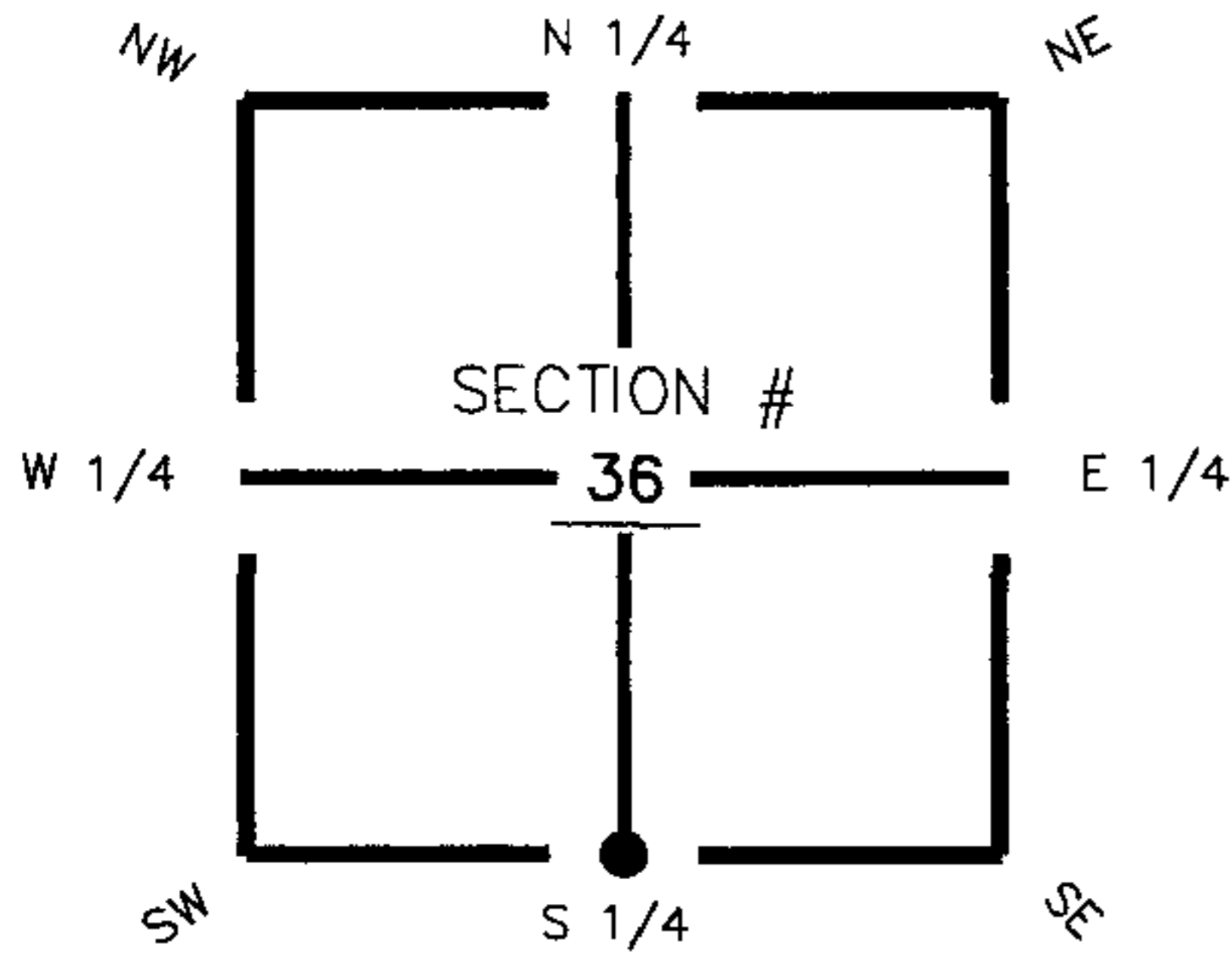

Found Lt. Wood Post

HORIZONTAL POSITION INFORMATION (if determined):

Latitude 26° 46' 10.16320" N Longitude 81° 34' 26.40548" W
 Y(NORTHING-Ft.) 885613.60 X(EASTING-Ft.) 795162.60 Zone FL83-WF
 Convergence 0° 11' 30.74461" Scale factor 0.999963327
 Coordinate determination (circle one): Field traverse GPS
 Horizontal datum (circle one): NAD27 NAD83(1986) NAD83(1999) other (explain)
 Accuracy (circle one): 1st 2nd 3rd other _____

S1/4 corner of Section 36
 Twp 42 South , Rge 27 East
 Tallahassee Base Meridian,
Charlotte County(s), Florida

1. 94' 16.60'. Set PK Nail and Trav. Pt. Disc (LB 642) in S. face of fence post.
2. 135' 12.20'. Set PK Nail and Trav. Pt. Disc (LB 642) in N. face of Cabbage Palm tree.
3. 275' 11.42'. Set PK Nail and Trav. Pt. Disc (LB 642) in S. face of fence post.

Section 36

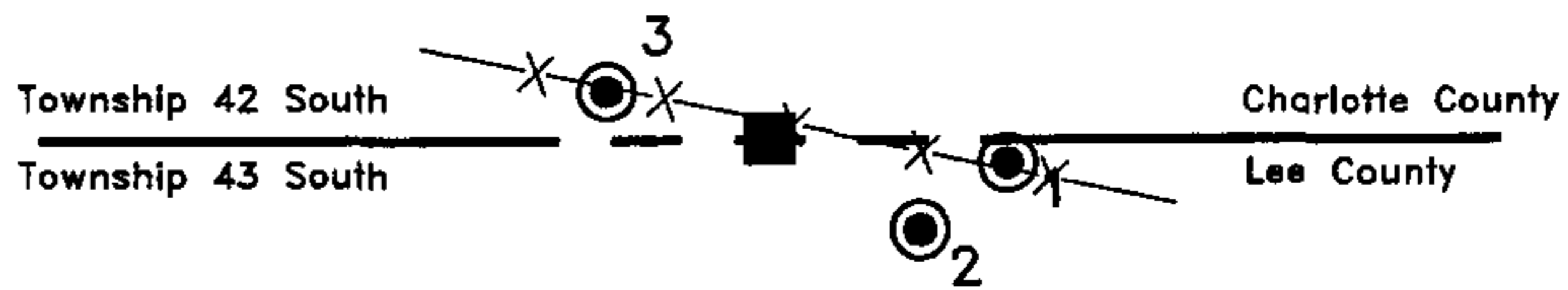
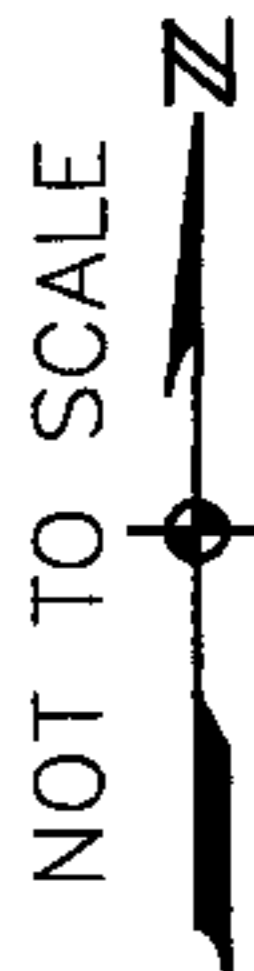

S. 1/4 Sec. 36, Twp. 42S., Rge. 27E.
 Found Lt. Wood Post
 0.5'S. of E.-W. fence line.

Section 1

Field Book: LB-31, Page 42

SURVEYORS CERTIFICATE:

I certify the monument and accessories indicated above were field located on August 31, 2005

[Signature]

 SIGNATURE 4912
 Johnson Engineering, Inc. PSM NO. 642

 FIRM OR AGENCY LB NO.
 251 West Hickpochee (SR80)

 ADDRESS
 Lg Belle STATE OF Florida 33935

 CITY STATE ZIP
 (863) 612-0594 November 1, 2005

 PHONE NUMBER DATE

EMBOSSSED SEAL OVER SIGNATURE

SEND ORIGINAL TO:
 Department of Environmental Protection
 Bureau of Surveying and Mapping
 3900 Commonwealth Boulevard
 Mail Station 105
 Tallahassee, Florida 32399

D.E.P. USE ONLY

Processed: 11-13-06 MB
 B.L.M. - I.D. 640100
 QUAD - I.D. 2313 Telegraphswamp SE