

FLORIDA DEPARTMENT OF ENVIRONMENTAL PROTECTION

CERTIFIED CORNER RECORD

85

DOC. # _____
 BLM. # T43SR26E400700

CORNER DESCRIPTION: MONUMENTATION DESCRIPTION (EVIDENCE FOUND OR METHOD TO SET)

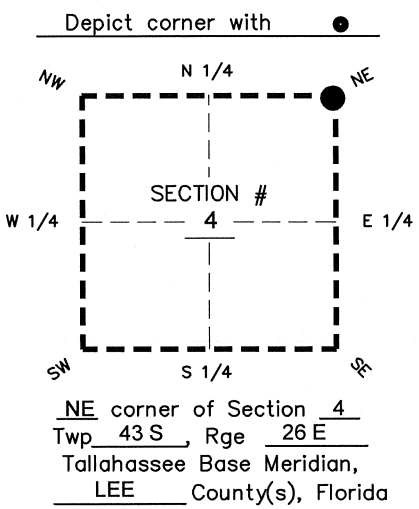

FOUND 4"x4" CONCRETE MONUMENT
 WITH CHARLOTTE COUNTY SURVEY
 DEPARTMENT BRASS DISK
 PROJECTS 0.2' ABOVE GROUND

PRIOR CCR'S:

DOC. # 020873, 089403

HORIZONTAL POSITION INFORMATION (if determined):

Latitude 26°46'09.3361" N Longitude 81°42'44.0136" W
 Y(NORTHING-Ft.) 885403.56 X(EASTING-Ft.) 750062.26 Zone WEST
 Convergence 00°07'46.6" Scale factor 0.99995128
 Coordinate determination: GPS
 Horizontal datum: NAD83(NSRS2007)
 Accuracy (circle one): 1st 2nd 3rd other 1:35,000

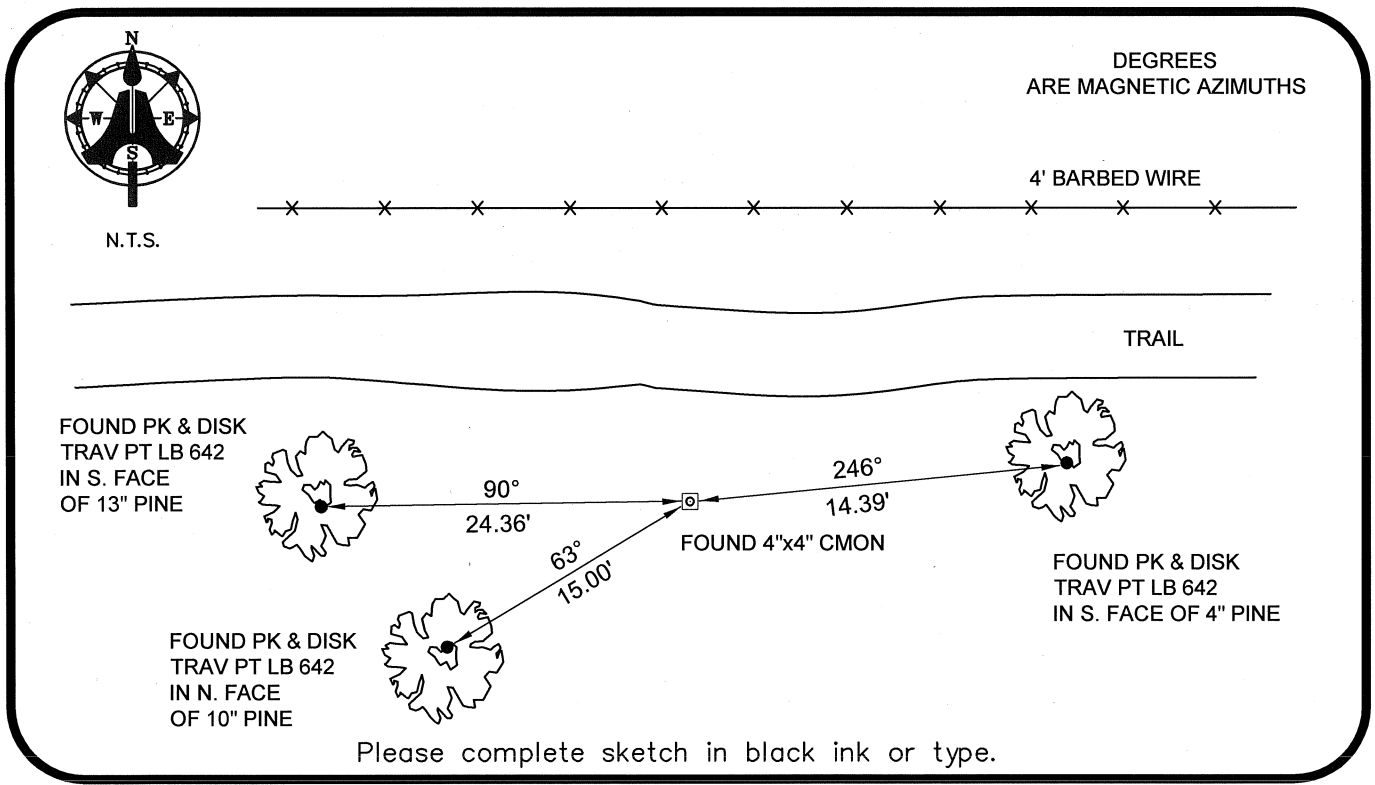

SURVEYORS CERTIFICATE:

I certify the monument and accessories indicated above were field located on 04-18-2008

BEN R. HOMOLA

 _____ 3950
SIGNATURE PSM NO.
 AIM ENGINEERING & SURVEYING, INC. 3114

FIRM OR AGENCY LB NO.
 5300 LEE BOULEVARD
 LEHIGH ACRES ADDRESS FL 33971

 CITY STATE ZIP
 (239)332-4569 07/30/2008

PHONE NUMBER DATE

SEND ORIGINAL TO:
 Department of Environmental Protection
 Bureau of Surveying and Mapping
 3900 Commonwealth Boulevard
 Mail Station 105
 Tallahassee, Florida 32399

D.E.P. USE ONLY	
Processed: _____	_____
B.L.M. - I.D. _____	_____
QUAD - I.D. _____	_____

EMBOSSSED SEAL OVER SIGNATURE