

1+00 1+50 2+00 2+50 3+00 3+50 4+00 4+50 5+00 5+50 6+00 6+50

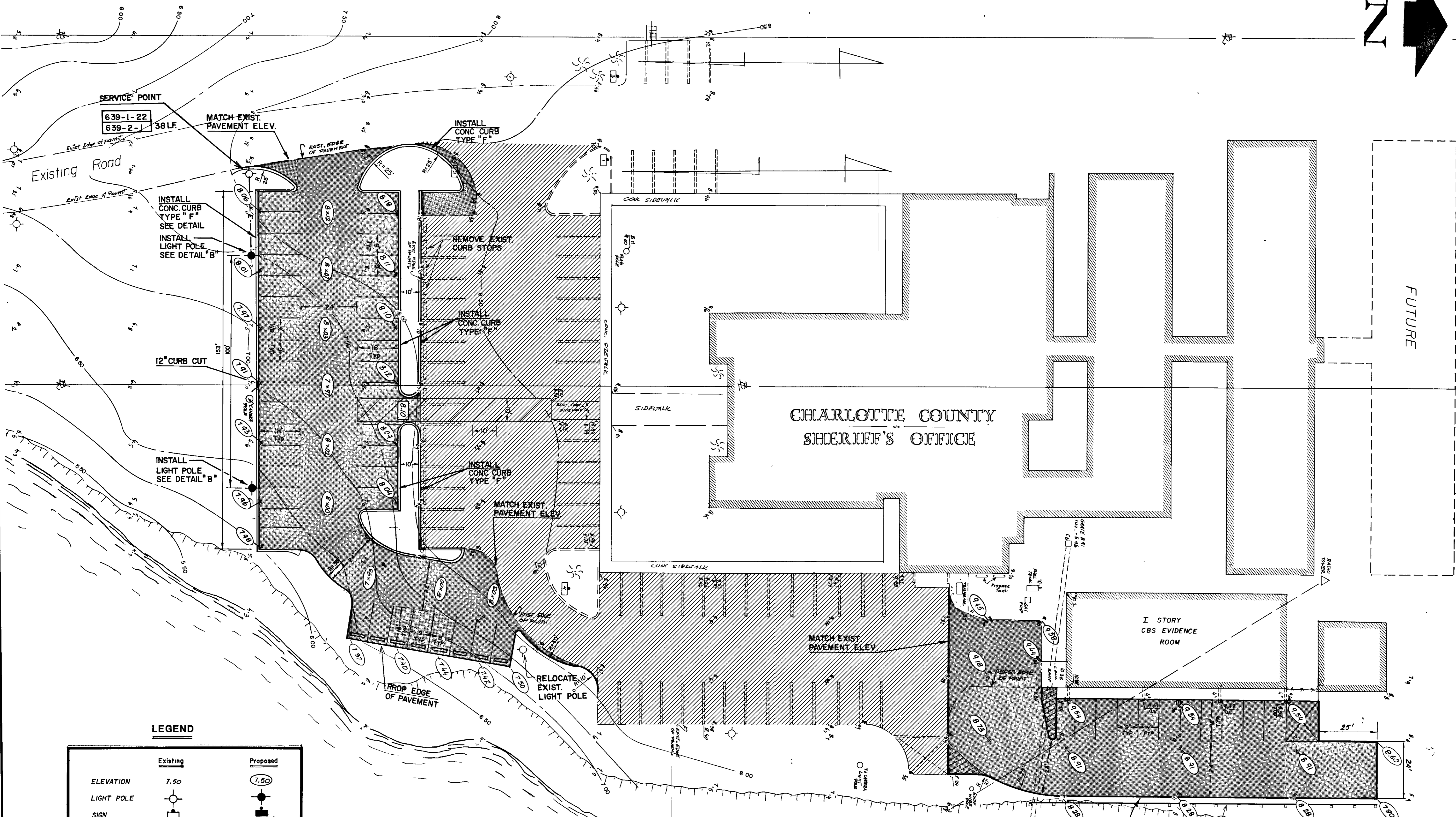
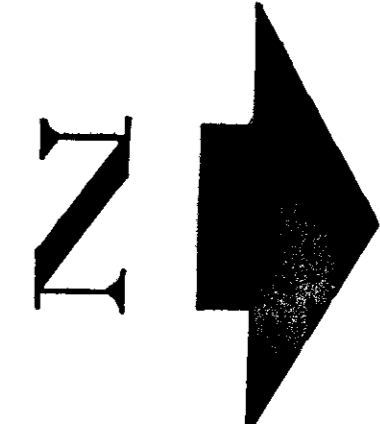

LEGEND

	Existing	Proposed
ELEVATION	7.50	(7.50)
LIGHT POLE		
SIGN		
CONC CURB		
CONTOUR LINE		
NEW PAVEMENT		
PLACE COALTAR EMULSION		

INSTALL 150 L.F. OF SINGLE FACED W/BAM TIMBER POST GUARD RAIL W/REFLECTORS SEE DETAIL "F"

	COUNTY OF CHARLOTTE COUNTY ENGINEERING DEPARTMENT PUNTA GORDA, FLORIDA
	CHARLOTTE COUNTY SHERIFF'S OFFICE ADDITIONAL PARKING LOT PLAN
	SCALE 1"=20' DES BY BB DRW BY CH CHK BY W J G
	SURVEYED BY P HART Field Book 176/12 APPROVED BY L. D. DATE 10-8-86 JOB No
SHEET 3 OF 5 DRAWING No 722	

